



## Adaptor for Skil 7492 Orbital Sander to 1.25" Shop-Vac Vacuum Hose



nleskiw

VIEW IN BROWSER

updated 9. 8. 2022 | published 9. 8. 2022

### Summary

This allows you to directly connect a 1.25" (31mm) Shop-Vac hose directly to the exhaust of a Skil 7492 Orbital Sander

[Hobby & Makers](#) > [Tools](#)

Tags: [orbitalsander](#) [randomorbitalsander](#) [sander](#) [sanders](#)  
[shopvac](#) [shopvacadapter](#) [shopvacattachment](#) [shopvaccoupler](#)  
[skil](#) [vacuum](#) [vacuumadapter](#) [vacuumcleaner](#)

This allows you to directly connect a 1.25" (31mm) Shop-Vac hose directly to the exhaust of a Skil 7492 Orbital Sander. [Link to OnShape model](#). It may work on other sanders with the following specs:

OD of exhaust port: Approx 38mm

Pins: 5mm diameter, front edge 17mm from end of exhaust port

Length of exhaust port: at least 28mm

I would print this with the small side down, so there's fewer overhangs. I just allowed support touching the model on the slots for the pins.

The connector on my sander had poor tolerance, so this is just a touch large.

If you feel it's too loose, shrink it a percent or two, or just add some electrical tape on the sander to make a snug fit. Now you can prevent most of the dust from escaping while sanding.

Be sure to use the fine paper filter in your shop vac and check it to make sure there's no clogs.

Always wear breathing protection when sanding.

## Model files



**hose-adaptor.3mf**

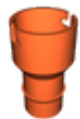

**hose-adaptor.stl**

## License

This work is licensed under a  
**Creative Commons (4.0 International License)**



**Attribution—Noncommercial—Share Alike**

- 
- ✗ | Sharing without ATTRIBUTION
  - ✓ | Remix Culture allowed
  - ✗ | Commercial Use
  - ✗ | Free Cultural Works
  - ✗ | Meets Open Definition

