



## Customizeable bushing adapter

 **chriszero**

[VIEW IN BROWSER](#)

updated 12. 4. 2022 | published 15. 3. 2020

### Summary

This is a adapter for bushings, eg. broncebearing.



0.53 hrs



1 pcs



0.20 mm



0.40 mm



PLA



3 g



Prusa  
MK2.5/S

[3D Printers](#) > [3D Printers - Upgrades](#)

Tags: [lm8uu](#) [bushing](#) [broncebearing](#)

This is a adapter for bushings, eg. broncebearing.  
I've paused the print at 19.75mm and inserted the broncebushings, then resumed printing.

I used <http://prusaprinters.org/color-print/> for that.

make a few tests while adjusting the inner diameter of the adapter, be sure the inserted bushing fits in tight!

### Print instructions

Pause print at 19.750mm (better check the height in your slicer!), insert bushing and resume printing.

## Model files

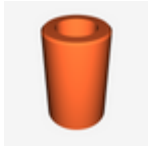

**bronze\_bushing\_adapter.stl**



**bronze\_bushing\_adapter.scad**

## Print files



**bronze\_bushing\_adapter\_02mm\_pla\_mk25.gcode**

🌀 PLA 📏 0.40 mm ⚖️ 0.20 mm ⌚ 0.53 hrs ⚖️ 3 g 🖨️ Prusa MK2.5/S

[Find source .stl files on Thingiverse.com](#)

## License ©

This work is licensed under a  
**Creative Commons (4.0 International License)**



### Attribution

- 
- ✗ | Sharing without ATTRIBUTION
  - ✓ | Remix Culture allowed
  - ✓ | Commercial Use
  - ✓ | Free Cultural Works
  - ✓ | Meets Open Definition