



Pinewood Derby Track 1":1mm scale



AHoward

[VIEW IN BROWSER](#)

updated 10. 8. 2022 | published 10. 8. 2022

Summary

1:25.4 scale model of my pinewood derby track

[Toys & Games](#) > [Vehicles](#)

Model files

full-track.stl



truncated.stl



☐ Full track, but with the 4 identical 4ft flat sections removed, between the curve & finish

start-gate.stl

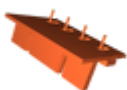



upper-ramp.stl

☐ First 4 feet of the 26-degree ramp. Includes cutouts for the starting gate.



upper-support.stl

☐ Support scaffolding for the upper portion of the ramp (ie: start section).



lower-ramp.stl

☐ Second 4 feet of the 26-degree ramp. Nearly identical to the standard 4ft section.



lower-support.stl



ramp-curve.stl

☐ Transition from 26-degrees to horizontal, over 44 inches, along a 97-inch radius.



4ft-section.stl

☐ A 4ft sheet of track. All sections are exactly this, or based on this.



finish-section.stl

☐ Standard 4ft section, but with cutouts for lasers & the finish gate base.



finish-gate.stl



stopping-distance.stl



upper-ramp.stl

☐ Upper ramp section, with support scaffolding & start gate attached, and demo cars on track.



lower-ramp.stl

☐ Lower ramp section, with support scaffolding attached.



finish-section.stl

☐ Last section of track, with finish gate attached.

License ©

This work is licensed under a
[Creative Commons \(4.0 International License\)](#)



Attribution—Noncommercial—Share Alike

- ✗ | Sharing without ATTRIBUTION
- ✓ | Remix Culture allowed
- ✗ | Commercial Use
- ✗ | Free Cultural Works
- ✗ | Meets Open Definition