



## Raspberry Pi-revised Prusa MINI+ display box - no logo



G.design

[VIEW IN BROWSER](#)

updated 1. 10. 2022 | published 1. 10. 2022

### Summary

Revised Prusa MINI+ display box for RPi, without the G.design's front logo

[3D Printers](#) > [3D Printers - Upgrades](#)

Tags: [display](#) [displaycase](#) [displaycover](#) [originalprusamini](#)  
[prusa](#) [prusamini](#) [prusaminiplus](#) [raspberrypi](#)  
[rasberrypicase](#) [rpi](#)

Revised Prusa MINI+ display box, designed to fit inside a Raspberry Pi Zero 2W.

For fixing the RPi board, you will need two M3x8 mm screws. It's connected to the Buddy control board via two cables - one USB A-to-micro USB for supplying power and one two sided micro USB for data transfer.

**IMPORTANT!!!**

1. Be sure that the micro USB-to-micro USB is DATA cable.
2. When adjusting the the position of the display, home the Z-axis first to avoid crashes with the Z stepper motor.

# This remix is based on

Raspberry Pi-revised Prusa MINI+ display box  
by G.design

## Model files

stl\_prusa-mini-rpi-display-box-front-cover-no-logo.stl

---

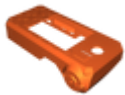

3mf\_prusa-mini-rpi-display-box-front-cover-no-logo.3mf

## License ©

This work is licensed under a  
[Creative Commons \(4.0 International License\)](#)



**Attribution-NonCommercial**

---

- ✗ | Sharing without ATTRIBUTION
- ✓ | Remix Culture allowed
- ✗ | Commercial Use
- ✗ | Free Cultural Works
- ✗ | Meets Open Definition