



## Rotatable tube clamp

**B** Buffedelic

[VIEW IN BROWSER](#)

updated 12. 4. 2022 | published 15. 3. 2020

### Summary

NOTE! This is a design by someone else, I had it on my computer but cannot remember where I got it from.

---

[Hobby & Makers](#) > [Mechanical Parts](#)

---

#### NOTE!

This is a design by someone else, I had it on my computer but cannot remember where I got it from. So to YOU; Thank you and I hope you won't get offended and all credit goes to you...

This is a standard scaffold tube clamp, rotatable. For 48mm

#### Print list:

Bracket x2, needs support  
Bracket Clamp x2, probably no support  
Clamp Bolt x2  
Nut x2  
Rivet Body x2  
Rivet Cap x2  
Center Rivet Body x1  
Center Rivet Cap x1

#### Assembly

Glue rivet bodies and caps after assembled in place.

## Print instructions Category: Engineering Print Settings

**Printer Brand:** Prusa

**Printer:** i3 MK3

**Rafts:** No

**Resolution:** 0.20

**Infill:** 20%

### Notes:

Use brim or raft to parts who have a first layer with small contact area.

## Model files



**center\_rivet\_body.stl**

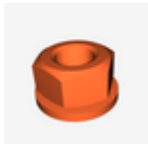

**nut\_m12.stl**



**bracket\_clamp.stl**

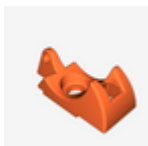

**bracket.stl**



**rivet\_body.stl**

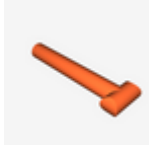

**clamp\_bolt.stl**

---



**center\_rivet\_cap.stl**

---



**rivet\_cap.stl**

[Find source .stl files on Thingiverse.com](https://www.thingiverse.com)

## License ©



This work is licensed under a  
**Creative Commons (4.0 International License)**

### **Attribution**

---

- ✘ | Sharing without ATTRIBUTION
- ✓ | Remix Culture allowed
- ✓ | Commercial Use
- ✓ | Free Cultural Works
- ✓ | Meets Open Definition