

3D MODEL ONLY



Miniature Painting Handle

joto314

VIEW IN BROWSER

updated 16. 8. 2022 | published 16. 8. 2022

Summary

An easy to print and use miniature Painting handle for various sizes of miniatures.

[Hobby & Makers](#) > [Tools](#)

Tags: [handle](#) [holder](#) [miniatures](#) [model](#) [painting](#) [vise](#) [modeling](#)

Features

- Gives you a solid grip on your miniature while painting
- Easily switch between various Base sizes without producing any waste or having to reprint anything
- Quickly switch out Miniatures
- Easy to print, no supports needed
- Minimal additional material required (some glue and a rubber Band)

Functionality

I designed this painting Handle as I was dissatisfied with various alternative options, who were either not keeping the miniature stable enough or were low in modularity or required a complex assembly and much additional hardware.

My goals were to design a pleasant to grip Handle which fully encloses the base of the miniature and keeps it completely stable. Additionally I wanted it to be easy to print and assemble and use (besides some glue) just a rubber band. Some alternatives used screws to keep the miniature in place which definitely worked but switching out miniatures was quite time consuming, so this handle was designed to make switching out miniatures fast and comfortable.

A note on base sizes

The current adapters are designed to work for the most common Games Workshop bases of the appropriate size. If you want more specialized adapters you can create them yourself (this is quite an easy CAD project suitable even for a beginner) or you can write me a message and I will see what I can do. Please include in the message some precise measurements, e.g. for a round base please include the radius or diameter and the angle of the sides.

What to print?

The parts you will need depend on what size the bases of your miniature are.

- **In all cases:** You will need to print all parts of the main handle
- **40mm Base:** No additional parts required
- **32mm Base:** In addition to the main handle you will need the 32mm adapter
- **25mm Base:** In addition to the main handle you will need the 25mm adapter
- **Other Base sizes:** Please see the section on base sizes, currently there are not other adapters available. but feel free to create them yourself or write me a message.
- **If you want multiple different sizes:** Print the parts for all desired base sizes. They can easily be swapped around.

Printing

Main Handle

In general you should use the flattest side of the model on the print bed. Your settings shouldn't be adjusted too much, the standard high quality settings of your printer (or whatever tuning works best for you) should work reasonably well, but disable support material if your slicer wants to insert it. I recommend printing all parts at 0.2mm layer height, except for

the **Main Handle**, where you might want to sacrifice a little bit of smoothness for a much lower printing time.

- Print the **Main Handle** upside down with the flat side on the print Bed. Please make sure that your settings are appropriate and that your printer is functioning well as this is by far the longest print
- Print the **Pins** upright on the print bed. I recommend printing them together or, even better, with some other parts, as they are very small
- Print the **Rails** with the flat sides on the print bed. I recommend enabling ironing for them
- Print the **Jaws** with the flat sides on the print bed. I recommend enabling ironing for all top surfaces for them

32mm Adapter

Print the **Jaws** upside down, such that the pins at the bottom are turned upwards. I recommend enabling ironing.

25mm Adapter

Print the **Jaws** with the flat sides on the bed, again I recommend ironing. You will additionally need to print the 4 Pins, they should not be printed individually. Print them all at once or, even better, together with some other parts.

Assembly

Main Handle

1. Insert the **Pins** into the main handle with some glue. If they are too tight (they weren't for my tests, but they may be for you) you can either print them again, scaled down.
2. Slide the **Fixed Jaw** on to the pins and glue them in place. Press fitting them might be enough, depending on the tolerances
3. Insert the **Rails** into the **Sliding Jaw** such that the thinner part is inside the Jaws and the thicker part is pointing outwards, glue them into place. See the picture below these Instructions.
4. Insert the **Sliding Jaws with their Rails** into the main part
5. Use a **rubber band** to tension the Jaws

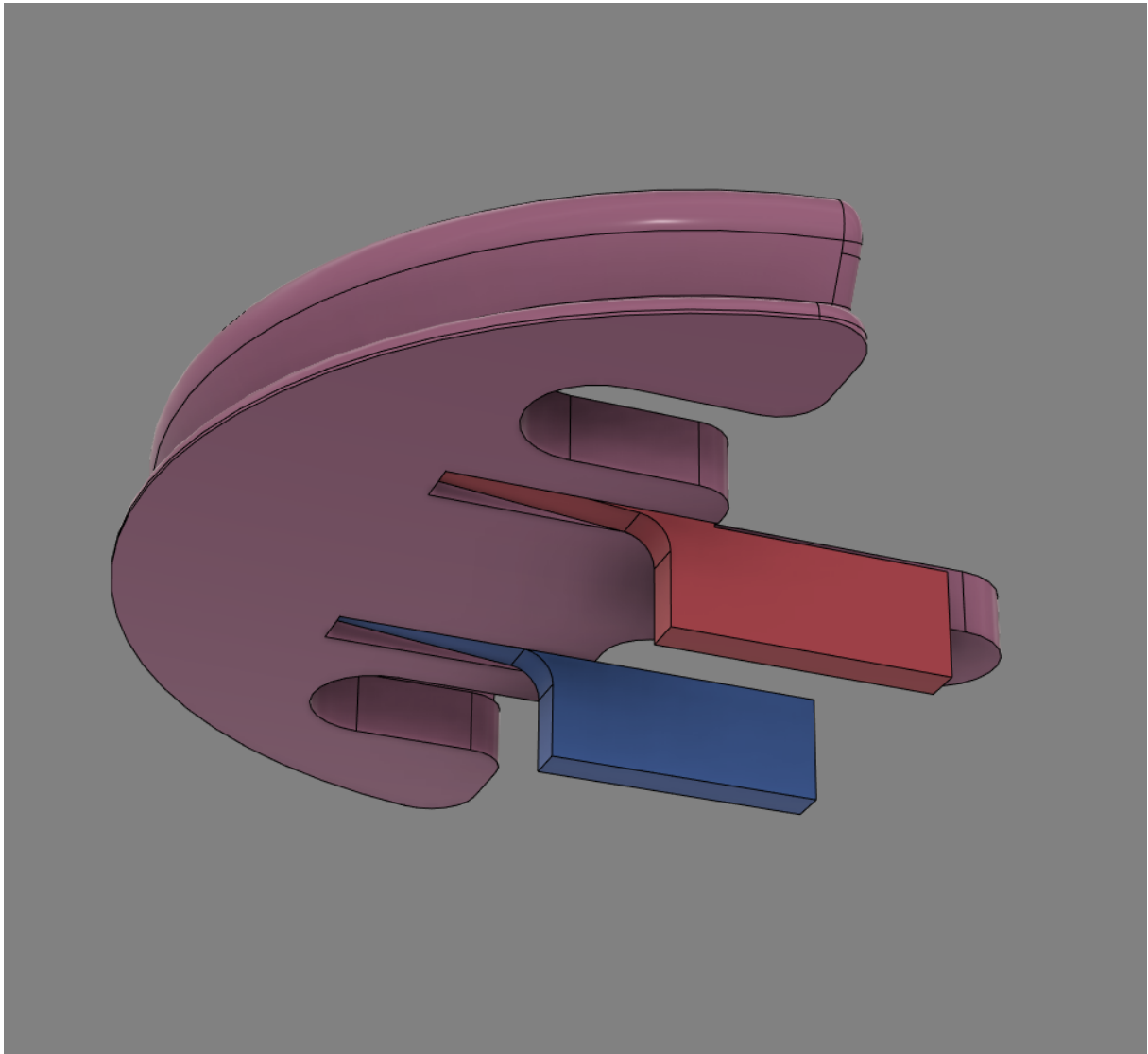

32mm Adapter

No assembly required, just insert the adapter into the jaws. The pins on the bottom of the adapter need to slide into the jaws.

25mm Adapter

Glue the pins into the holes of the adapters, then proceed as in the case for the 32mm adapter.

I hope that you find this handle to your liking and I wish you happy printing and happy painting!

Model files



miniature-painting-handle.3mf



32mm-adapter.3mf



25mm-adapter.3mf

License

This work is licensed under a
[Creative Commons \(4.0 International License\)](https://creativecommons.org/licenses/by/4.0/)



Attribution

- ✗ | Sharing without ATTRIBUTION
- ✓ | Remix Culture allowed
- ✓ | Commercial Use
- ✓ | Free Cultural Works
- ✓ | Meets Open Definition