



Nintendo switch lite dock

LTRJ Logan Jones

[VIEW IN BROWSER](#)

updated 10. 8. 2022 | published 10. 8. 2022

Summary

A Display stand for the Nintendo switch lite, in the style of the Nintendo switch dock.

[Gadgets](#) > [Portable Devices](#)

Tags: [dock](#) [holder](#) [nintendo](#) [stand](#) [storage](#) [switch](#)

*****This dock does not allow for charging, however***** you can feel free to remix it and allow for a charger to be added.

This is an improved switch dock that I designed to look like the Nintendo Switch OLED dock.

I have previously designed a switch lite dock, but I didnt ever like the look of it, so I started from scratch and designed this one with lots of trial and error. The Nintendo Switch logo is cantered on the front like the switch OLED dock.

For this dock to work without the case you will have to resizes the y axis by only a few mm. This dock is designed to work with the HEYSTOP Case for the Nintendo Switch Lite. The link amazon.co.uk/gp/product/B0948T7NXB/ref=ppx_yo_dt_b_asin_title_o05_s00?ie=UTF8&th=1 (not an affiliate link)

Does not require any supports.

Any inquires feel free to leave a comment and I will try to help, Happy Printing.

Model files

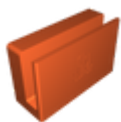

nintendo-switch-lite-dock.stl

License ©

This work is licensed under a
[Creative Commons \(4.0 International License\)](#)



Attribution-NonCommercial

-
- ✗ | Sharing without ATTRIBUTION
 - ✓ | Remix Culture allowed
 - ✗ | Commercial Use
 - ✗ | Free Cultural Works
 - ✗ | Meets Open Definition