

## Filament Hub Expander



Luce

[VIEW IN BROWSER](#)

updated 11. 8. 2022 | published 11. 8. 2022

### Summary

Increases the diameter of an empty filament hub for the filament to go around from the drying box to the extruder.

---

[3D Printers](#) > [3D Printers - Upgrades](#)

---

Tags: [expander](#) [filament](#)

---

Print two C hub expanders (3.090" ID) on their sides using 10% honeycomb fill. Print 4 Pins standing up. The pins slide right into the holes. Get an empty filament hub and sandwich it between the two hub expanders with pins in the holes. You may want to glue it together, but I didn't have to.

Also had to print the filament hub internal (ID 0.936", OD 2.85") to increase the diameter of the Prusa filament spool holder to match the hub size. Press fit the filament hub into the outside of the Prusa spool holder. Make sure it's the right size for you, because once you press fit it in, it's not coming out easily.

# Model files



**filament-hub-internal2.sldprt**

---



**filament-hub-internal2.3mf**

---

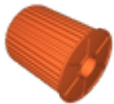

**filament-hub-internal2.stl**

---



**filament-hub-expander.3mf**

---



**filament-hub-expander.stl**

---



**filament-hub-expander.sldprt**

---



**pin.3mf**

---



**pin.sldprt**

---



**pin.stl**

# License

This work is licensed under a  
**Creative Commons (4.0 International License)**



**Attribution-ShareAlike**

---

- ✗ | Sharing without ATTRIBUTION
- ✓ | Remix Culture allowed
- ✓ | Commercial Use
- ✓ | Free Cultural Works
- ✓ | Meets Open Definition