



## Tachi Season One Guns

L Lewis

[VIEW IN BROWSER](#)

updated 12. 8. 2022 | published 12. 8. 2022

### Summary

I modified the guns to add multiple mounting heights and (for me) a cleaner build.

[Toys & Games](#) > [Vehicles](#)

This remix provides for three different heights of guns which I use at front, middle and back. It also has a plate to take the place of the retractor.

The parts are held together with two small black hex screws. They are either 2mm/2.5mm or 2.5/3.0, sorry don't remember which. All of the parts have a flat surface to print from. the base needs supports for the second level and they can be difficult to remove. Use the support edit tools to print just the minimum you need. Ditto for the high turret. I had the guns and the magazines printed on a resin printer, but the rest is on my prusa 3.

### This remix is based on



**Rocinante from Expanse**

by Martin

# Model files

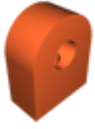

**my\_gun\_turret\_loop.stl**

---

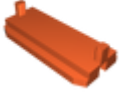

**my\_pdc\_extender.stl**

---



**my\_gun\_base\_5.stl**

---



**my\_gun\_turret\_low.stl**

---



**my\_gun\_turret\_high.stl**

---



**my\_gun\_turret\_mid.stl**

---



**my\_gun\_barrel.stl**

---



**my\_gun\_back\_screw\_2.stl**

---



**xxx\_-\_pdc\_mag1.stl**

---

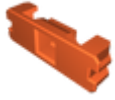

xxx\_-\_pdc.stl



xxx\_-\_pdc\_filler.stl



xxx\_-\_pdc\_cannon2.stl



xxx\_-\_pdc\_mag2.stl

## License

This work is licensed under a  
[Creative Commons \(4.0 International License\)](https://creativecommons.org/licenses/by/4.0/)



### Attribution

- ✗ | Sharing without ATTRIBUTION
- ✓ | Remix Culture allowed
- ✓ | Commercial Use
- ✓ | Free Cultural Works
- ✓ | Meets Open Definition