



## Bins For Husky 6 in. 6-compartment Bins



**Brian Huang**

[VIEW IN BROWSER](#)

updated 14. 4. 2024 | published 14. 4. 2024

### Summary

Bins for Bins -- These are a variety of bins that fit the Husky 6 in. - compartment bins.

[Hobby & Makers](#) > [Organizers](#)

Tags: [bins](#)

Bins for Bins -- These are a variety of bins that fit the **Husky 6 in. 6-compartment bins**. These bins are designed to be 3D printed and allow for 2 layer thicknesses in the walls - if you're using a 0.4 mm nozzle.

There are two variants here - full height and nested. The nested bins are half height and allow for the bins to be split in half with allow for stacking. These bins are designed to fit the standard Husky 6 in.

On-shape 3D Model available [here](#).

### This remix is based on

Onshape

**Onshape**

## Model files



### Nested Half Bins

8 files

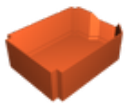

**left-front-nested-upper.stl**



**center-rect-nested.stl**

☐ Upper and Lower for the rear row and only lower for the front row. Print a total of 3x for each



**center-rect-front-nested-upper.stl**

☐ Upper front has a notch cut out to allow for the lid to close properly. Print 1x per bin.

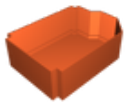

**left-front-nested.stl**

☐ Matching nested bins for left front. Measures exactly 1/2 the total height. Print 2x per bin.

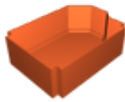

**right-front-nested.stl**

☐ Matching nested bins for right front. Measures exactly 1/2 the total height. Print 2x per bin.

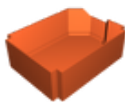

**right-front-nested-upper.stl**

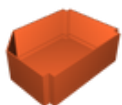

**right-rear-corner-nested.stl**

☐ Matching nested bins for rear right. Measures exactly 1/2 the total height. Print 2x per bin.

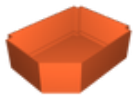

### **left-rear-corner-nested.stl**

☐ Matching nested bins for rear left. Measures exactly 1/2 the total height. Print 2x per bin.



## **Full Height Bins**

6 files



### **rear-right-corner-full-height.stl**



### **rear-center-rect-full-height.stl**



### **rear-left-corner-full-height.stl**



### **front-left-corner-full-height.stl**



### **front-right-corner-full-height.stl**



### **front-center-rect-full-height.stl**

[Find source .stl files on Thingiverse.com](#)

# License

This work is licensed under a  
**Creative Commons (4.0 International License)**



**Attribution-ShareAlike**

---

- ✗ | Sharing without ATTRIBUTION
- ✓ | Remix Culture allowed
- ✓ | Commercial Use
- ✓ | Free Cultural Works
- ✓ | Meets Open Definition