



## Small ceramic twisted vase



Gilles160

[VIEW IN BROWSER](#)

updated 7. 10. 2022 | published 7. 10. 2022

### Summary

This is a ceramic copy obtained from the original 3D design



64.53 hrs



11 pcs



0.20 mm



0.40 mm



PLA



918 g



Prusa  
MK3/S/S+

[Art & Design](#) > [Sculptures](#)

Tags: [decorationvase](#) [flowervase](#) [spiralvase](#) [vase](#)

This is my second ceramic vase obtained from a 3D printed mould

The design becomes quite effective.

- Easier to assemble
- The plaster mould is not too heavy

And the two peaced that I used to assemble the plater pieces together is a very good idea

Enjoy

# This remix is based on



## Small twisted vase

by Gilles160

## Model files

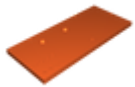

cote2.3mf



bottom.3mf



couvercle4.3mf



couvercle3.3mf



couvercles.3mf

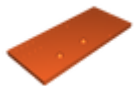

cote1.3mf



base.3mf



**couvercle1.3mf**

---



**demi-coque-avec-vis.3mf**

---



**couvercle2.3mf**

---

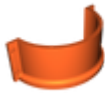

**demi-coque-avec-ecrous.3mf**

---



**fond.3mf**

---



**top.3mf**

---



**tour.3mf**

---

## Print files



**couvercles\_02mm\_pla\_mk3s\_2h41m.gcode**

🌀 PLA   🌀 0.40 mm   ≡ 0.20 mm   ⌚ 2.69 hrs   ⚖️ 29 g   🖨️ Prusa MK3/S/S+

---



### couvercles\_02mm\_pla\_mk3s\_2h24m.gcode

🌀 PLA 📏 0.40 mm ⚖️ 0.20 mm ⌚ 2.40 hrs ⚖️ 28 g 📄 Prusa MK3/S/S+



### cote2\_02mm\_pla\_mk3s\_3h56m.gcode

🌀 PLA 📏 0.40 mm ⚖️ 0.20 mm ⌚ 3.93 hrs ⚖️ 76 g 📄 Prusa MK3/S/S+



### base\_02mm\_pla\_mk3s\_2h39m.gcode

🌀 PLA 📏 0.40 mm ⚖️ 0.20 mm ⌚ 2.65 hrs ⚖️ 28 g 📄 Prusa MK3/S/S+



### cote1\_02mm\_pla\_mk3s\_3h54m.gcode

🌀 PLA 📏 0.40 mm ⚖️ 0.20 mm ⌚ 3.90 hrs ⚖️ 76 g 📄 Prusa MK3/S/S+



### bottom\_02mm\_pla\_mk3s\_9h4m.gcode

🌀 PLA 📏 0.40 mm ⚖️ 0.20 mm ⌚ 9.07 hrs ⚖️ 124 g 📄 Prusa MK3/S/S+

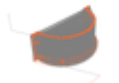

### demi-coque-avec-ecrous\_02mm\_pla\_mk3s\_7h34m.gcode

🌀 PLA 📏 0.40 mm ⚖️ 0.20 mm ⌚ 7.57 hrs ⚖️ 89 g 📄 Prusa MK3/S/S+



### tour\_02mm\_pla\_mk3s\_6h48m.gcode

🌀 PLA 📏 0.40 mm ⚖️ 0.20 mm ⌚ 6.80 hrs ⚖️ 95 g 📄 Prusa MK3/S/S+



### top\_02mm\_pla\_mk3s\_9h16m.gcode

🌀 PLA 📏 0.40 mm ⚖️ 0.20 mm ⌚ 9.26 hrs ⚖️ 127 g 📄 Prusa MK3/S/S+



### demi-coque-avec-vis\_02mm\_pla\_mk3s\_7h31m.gcode

🌀 PLA 📏 0.40 mm ⚖️ 0.20 mm ⌚ 7.51 hrs ⚖️ 88 g 📄 Prusa MK3/S/S+



## fond\_02mm\_pla\_mk3s\_8h45m.gcode

PLA 0.40 mm 0.20 mm 8.75 hrs 159 g Prusa MK3/S/S+

## License



This work is licensed under a  
[Creative Commons \(4.0 International License\)](#)

**Attribution—Noncommercial—Share Alike**

- 
- ✗ | Sharing without ATTRIBUTION
  - ✓ | Remix Culture allowed
  - ✗ | Commercial Use
  - ✗ | Free Cultural Works
  - ✗ | Meets Open Definition