



RC Car body post cutter



Mark_McQ

[VIEW IN BROWSER](#)

updated 7. 10. 2022 | published 7. 10. 2022

Summary

A cutter and chamfer tool for Rc car body posts.

[Hobby & Makers](#) > [RC & Robotics](#)

Tags: [bodypost](#) [rccar](#) [tamiya](#)

This a pair of tools to cut the body posts for an RC car and add a small chamfer to the top.

To use the cutter, put your lower split pin into the post where it would sit under the body and then push the post into the cutter until the pin hits the bottom. Then turn the thumbwheel to cut the post to approx 5mm above the split pin.

The post can be chamfered by pushing it in through the bottom side of the chamfer tool and rotating it against the blade.

Required parts for assembly:

2 standard Stanley Blades

2 M3x3 bolts (Chamfer tool)

2 M3 x 6 bolts (Cutter)

1 x M5x30 bolt (Head must be around 8mm across the flat sides). this goes through the thumbwheel.

Optional, not required:

M5 brass heat insert. If you don't have one of these you can print the 'NoInsert' variant of the main cutter body and manually thread the hole on it using a tap or the M5 bolt.

Optionally, you can also put a spring inbetween the main body and slide so that they separate automatically when you wind the thumbscrew out.

All the cutter parts can be printed without any supports. I've included two screenshots showing the orientation for this.

Model files



bevel_tool.stl

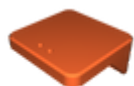

slide.stl



main_noinsert.stl

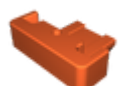

main.stl



thumbscrew.stl

License ©

This work is licensed under a
[Creative Commons \(4.0 International License\)](https://creativecommons.org/licenses/by-nc-nd/4.0/)



Attribution—Noncommercial—No Derivatives

- ✗ | Sharing without ATTRIBUTION
- ✗ | Remix Culture allowed
- ✗ | Commercial Use
- ✗ | Free Cultural Works
- ✗ | Meets Open Definition