



## Raspberry pi camera flat cable holder for 2020 aluminum extrusion ends



Mr.President

[VIEW IN BROWSER](#)

updated 4. 9. 2023 | published 4. 9. 2023

### Summary

This is a cable holder for the raspberry pi flat camera cable.

[3D Printers](#) > [3D Printers - Upgrades](#)

Tags: [cr10](#) [2020](#) [prusai3mk3](#) [raspberrypicase](#) [rasberry](#) [2020extrusion](#) [raspberrypicamera](#) [raspberrypi3](#) [flatcable](#) [prusamk4](#)

This is a cable holder for the Raspberry Pi flat camera cable. it fits the side of 2020 extrusion ends frame or any other frame like that. you will need to take off the frame plastic cover and connect this holder instead of him. I don't know what is the right name for that piece of plastic but I added a picture of it.  
Have fun!

# Model files

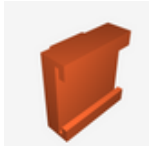

camerapicableholder.stl

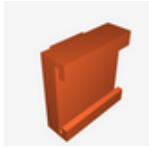

camerapicableholder.stl

## License ©

This work is licensed under a  
[Creative Commons \(4.0 International License\)](#)



**Attribution-ShareAlike**

- 
- ✗ | Sharing without ATTRIBUTION
  - ✓ | Remix Culture allowed
  - ✓ | Commercial Use
  - ✓ | Free Cultural Works
  - ✓ | Meets Open Definition