

DC toggle switch side mount panel



ballanux

[VIEW IN BROWSER](#)

updated 8. 10. 2022 | published 8. 10. 2022

Summary

For mounting a toggle switch sideways to a panel with only one screw

[Hobby & Makers](#) > [Electronics](#)

Tags: [createdwithfreecad](#) [panelmount](#) [switch](#)

A simple and easy way to mount a DC switch to a panel, specially if you can't mount it through the panel due to the panel thickness.

It only uses one M3 screw for mounting so it is very compact.

Print with 100% infill and 0.2 layers

The FreeCAD 0.20 source model is included in case you want to modify it

Model files

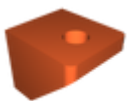

dcswitchmount.stl



toggle_switch_holder_v01_20221002.fcstd

License

This work is licensed under a
Creative Commons (4.0 International License)



Attribution

- ✗ | Sharing without ATTRIBUTION
- ✓ | Remix Culture allowed
- ✓ | Commercial Use
- ✓ | Free Cultural Works
- ✓ | Meets Open Definition