



## Reversed PSX Vertical Stand



RP2A03

[VIEW IN BROWSER](#)

updated 12. 10. 2022 | published 12. 10. 2022

### Summary

My current retro corner configuration and my OCD forced me to learn a basic move in Blender (boolean difference).

[Gadgets](#) > [Video Games](#)

Tags: [playstation](#) [psx](#) [stand](#) [vertical](#) [rp2a03](#) [retrofrog](#)

This stand looks awesome, but the way the cables hanged in the side of my monitor made my eyes twitch. At first I thought I could just mirror the model but I had to cut the hole for the reset button, I did my best with my limited Blender experience.

I think some of you might enjoy the possibility of placing the PSX on the other side.

I added another version of the stl with higher walls for better aesthetics.

I will upload pics when it's printed.

Follow me on Twitter for music and retrogaming scene updates.

[twitter.com/RP2A03G](https://twitter.com/RP2A03G)

# This remix is based on



## PlayStation 1 Vertical Stand

by Retro Frog

## Model files

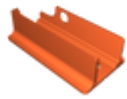

### psx\_stand-reversed-rp2a03\_remix\_improved.stl

☐ "improved" higher walls for aesthetics

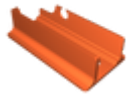

### psx\_stand-reversed-rp2a03\_remix.stl

☐ first try same size as original

[Find source .stl files on Thingiverse.com](#)

## License ©

This work is licensed under a  
**Creative Commons (International License)**



**Public Domain**

- 
- ✓ | Sharing without ATTRIBUTION
  - ✓ | Remix Culture allowed
  - ✓ | Commercial Use
  - ✓ | Free Cultural Works
  - ✓ | Meets Open Definition