

CoolerMaster Riser Cable Vertical Mount Bracket for Fractal Design Meshify 2

 **boogle**

[VIEW IN BROWSER](#)

updated 8. 10. 2022 | published 8. 10. 2022

Summary

Bracket to allow vertical mounting of a GPU using a CoolerMaster 300mm Riser Cable in a Fractal Design Meshify 2 case.

[Gadgets](#) > [Computers](#)

Tags: [bracket](#) [meshify2](#) [meshify2xl](#) [riser](#) [verticalgpu](#)

This is a bracket to allow native installation of a CoolerMaster Riser Cable PCIe 4.0 16x 300mm in a Fractal Design Meshify 2 XL (non XL should also work). The bracket screws into the cage over the PSU as the native Fractal Design riser would.

Use two 'Mounting Screw (6-32)' screws to mount the bracket to the case. The riser will then rest on top of the bracket. There is a lip at the front to hold the bracket / GPU in place, and a block behind to support the cable and ensure the card naturally wants to tilt forward. This should be enough to keep the GPU in place and straight.

The 300mm cable is handy in the Meshify 2 XL since it's long enough to route around add-in cards behind the GPU while also comfortably reaching the primary PCIe slot on the motherboard.

Due to the lack of specific screw mounts for the riser, it might be possible to use this bracket with other riser cables that use a surface-mount PCIe slot. However, I've only tested specifically with the CoolerMaster riser.

Model files

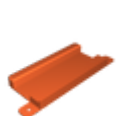

bracket.stl

License ©

This work is licensed under a
[Creative Commons \(4.0 International License\)](#)



Attribution—Noncommercial—Share Alike

-
- ✗ | Sharing without ATTRIBUTION
 - ✓ | Remix Culture allowed
 - ✗ | Commercial Use
 - ✗ | Free Cultural Works
 - ✗ | Meets Open Definition