

Duct Flage (window)

t thinkingaloud

VIEW IN BROWSER

updated 9. 10. 2022 | published 9. 10. 2022

Summary

Duct flange designed for my enclosure to help with venting.

[3D Printers](#) > [Accessories](#)

Tags: [duct](#) [enclosure](#) [fanduct](#) [flange](#)

My enclosure has a built in fan over an opening. I wanted to be able to control where it vents out to (a nearby window), so I purchased 4in ducting on [Amazon](#). This is designed to fit in my side-to-side window and be held in place with the sliding window.

The box is 44.5mm x 170mm x 150mm. The flange part is 100mm in diameter and 25mm tall, which should give enough space for 4in ducting to be placed over it and secured.

It also has four 35mm x 35mm x 0.8mm slots for some metal squares so a magnetic sheet can be secured on top as a cover while printing.

See my [other model](#) for what the other side of the duct is attached to.

Model files

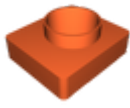

enclosure_window_duct_v1.stl

License



This work is licensed under a
[Creative Commons \(4.0 International License\)](#)

Attribution—Noncommercial—Share Alike

-
- ✗ | Sharing without ATTRIBUTION
 - ✓ | Remix Culture allowed
 - ✗ | Commercial Use
 - ✗ | Free Cultural Works
 - ✗ | Meets Open Definition