

## Ender external case display mounts and cover clips



GMur

[VIEW IN BROWSER](#)

updated 9. 10. 2022 | published 9. 10. 2022

## Summary

Created Mounts to bring Ender V2 display out of Creality case. During testing, I realised that I had created clips to...

---

[3D Printers](#) > [Accessories](#)

---

Tags: mount

---

Created Mounts to bring Ender V2 display out of Creality case.

During testing, I realised that I had created clips to hold the fabric a bit tighter. (It does sag a little bit).

I did the base mount first, used a corner to make the mount more rigid. I then thought a clip on the side of the creality frame might work as well.

Print upright for clip models and flat for base model (see screenshots of Cura)

This gives the part a bit of flex in the right direction on the clips

## Print Settings

**Printer Brand:**

Creality

**Printer:**

Ender 3

**Rafts:**

No

**Supports:**

Yes

**Resolution:**

0.2

**Infill:**

20

**Filament:** Pantech PLA Does Not Matter

**Notes:**

Print upright (see screenshots of Cura)  
This gives the part a bit of flex in the right direction.

Category: 3D Printer Accessories

## Model files

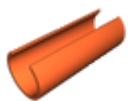

**creality\_fabric\_clip.stl**

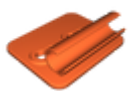

**ender\_3\_crealty\_case\_clip\_mount\_display.stl**



**lh\_ender\_v2\_display\_mount.stl**

# License ©

This work is licensed under a  
**Creative Commons (4.0 International License)**



## Attribution

---

- ✗ | Sharing without ATTRIBUTION
- ✓ | Remix Culture allowed
- ✓ | Commercial Use
- ✓ | Free Cultural Works
- ✓ | Meets Open Definition