



Wallmount for Tint Zigbee remote control

 **Steve Höfner**

[VIEW IN BROWSER](#)

updated 9. 10. 2022 | published 9. 10. 2022

Summary

The original remotecontrol does not hold the remote very well. It often happened that the remote fall down.

[Household](#) > [Other House Equipment](#)

Tags: [remote](#) [wallmount](#)

I printed it in pla.

The remote can be easily removed for battery change.

No support is needed.

Model files

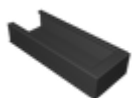

tint-v2.3mf

License

This work is licensed under a
Creative Commons (4.0 International License)



Attribution-NonCommercial

- ✗ | Sharing without ATTRIBUTION
- ✓ | Remix Culture allowed
- ✗ | Commercial Use
- ✗ | Free Cultural Works
- ✗ | Meets Open Definition