

## mounting plate for biqu h2 v2 for minda d3

 psmaker

[VIEW IN BROWSER](#)

updated 10. 10. 2022 | published 10. 10. 2022

## Summary

mounting plate for biqu h2 v2 for minda d3

[3D Printers](#) > [3D Printers - Upgrades](#)

Tags: [biquh2](#) [mingdad2](#)

you will need 3 m3\*h3 heat inserts and 2 m3x12 countersunk screws to mount this,

works best with the fan mount, duct and bltouch mounts from here:

<https://www.thingiverse.com/thing:5202213>

## Model files

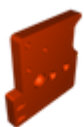

biqu\_h2\_v2\_on\_d2.3mf

# License

This work is licensed under a  
**Creative Commons (4.0 International License)**



**Attribution-ShareAlike**

---

- ✗ | Sharing without ATTRIBUTION
- ✓ | Remix Culture allowed
- ✓ | Commercial Use
- ✓ | Free Cultural Works
- ✓ | Meets Open Definition