



## X-Axis Cover Flat Cable Management System



Kinematic Digit

VIEW IN BROWSER

updated 10. 10. 2022 | published 10. 10. 2022

### Summary

X-Axis Cover Flat Cable Management for supplied Creality Sprite Extruder Pro.

[3D Printers](#) > [3D Printers - Upgrades](#)

Tags: [cableholder](#) [cablemanagement](#) [crealityender3v2](#)  
[ender3v2](#) [spriteextruderpro](#) [xaxiscarriage](#)

On my Creality Sprite Extruder Pro, I moved my supplied cable to the front of the Z supports for better clearance with this design:

<https://www.thingiverse.com/thing:5508849>

It works great, but I did not like how the cables went to the side and required more table clearance. I designed my own X-Axis cap cover that snaps on the existing one and allows me to manage the cable in a front and back orientation.

This build includes the X-Axis cover and dual V-Slot rail support to manage the front and back of the cable. You'll have to re-route the cables underneath the printer and out to the side instead of the back of the printer. You'll also have to loosen off the three screws that hold the motherboard housing to the frame (two in front, one on top and back which is the screw that goes into the frame, not the smaller screw that holds the motherboard in place) so you can slide the mount on. I have a custom PSU cover that has custom zip-tie mounts so that makes it easier

for me. It's not totally necessary, but you can also just let those cables hang below the printer.

I did not put a cable chain on my design as it needs a 45-degree twist to operate freely. Lots of zip strips manage both my LED cable and flat cable together. You could add a cable chain below the X-Axis holder and to the rail support but I leave that to the community to come up with their own ideas.

I recommend printing with supports even though it will require some finicky clean up. Tree supports in Cura works well, or add in your own supports manually.

## Model files



**rail-cablemanagement-flatcable.stl**

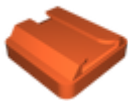

**x-axis-cable-manager-flatcable.stl**

## License

This work is licensed under a  
[Creative Commons \(4.0 International License\)](https://creativecommons.org/licenses/by/4.0/)



### Attribution

- 
- ✗ | Sharing without ATTRIBUTION
  - ✓ | Remix Culture allowed
  - ✓ | Commercial Use
  - ✓ | Free Cultural Works
  - ✓ | Meets Open Definition