

Small hinges (for fusebox door)



vanhee_sander

[VIEW IN BROWSER](#)

updated 10. 10. 2022 | published 10. 10. 2022

Summary

Set of small hinges to replace the broken hinges on the door of my 30 year old fusebox. Created in Onshape

[Household](#) > [Other House Equipment](#)

Tags: [abb](#) [fusebox](#) [hinge](#) [vynckier](#)

The hinges on the door of my 30 year old ABB Vynckier fusebox broke and needed replacement.

One part of the door still has the original rod to clip into (part 1) and the other one was broken too so I designed a new complete hinge (part 2 and 3). Both hinges should swing around the same centerpoint so the door opens evenly. When installing / gluing, consider the orientation of the bottom part so the protrusion point upwards and your door does not fall down when opening :)

Hole is sized for a self-tapping screw to fix the hinge into the fusebox.

Printed in PETG because PLA proved to be too brittle when snapping the hinge in place.

Model files



abb-vynckier-hinge-v3.stl

📄 (Part 1) Hinge that snaps in the original rod

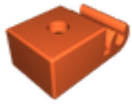

hinge-a.stl

📄 (Part 2) Use with part 3 and make sure part 2 faces up

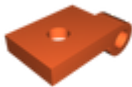

hinge-b.stl

📄 (Part 3) Use with part 2 and make this the top part

License ©

This work is licensed under a
[Creative Commons \(4.0 International License\)](#)



Attribution

- ✗ | Sharing without ATTRIBUTION
- ✓ | Remix Culture allowed
- ✓ | Commercial Use
- ✓ | Free Cultural Works
- ✓ | Meets Open Definition