

## Portal gun



G33kt3ch studio

[VIEW IN BROWSER](#)

updated 11. 10. 2022 | published 11. 10. 2022

## Summary

Portal gun From portal and portal 2. This is to scale.

[Costumes & Accessories](#) > [Props](#)

Tags: [cosplay](#) [portal](#) [portal2](#) [props](#)

This is my version of the portal gun from portal and portal 2.

modeled from lots of screen shots.

modeling was done in blender and then moved to fusion to make it more printable.

will upload more pictures soon. the portal gun is downstairs at the moment and im to lazy after ERRF2022 to go downstairs and take pictures.

## Model files



**light-chamber.stl**



**back-shroud-left.stl**

---



**handle.stl**

---

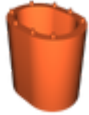

**main-body-middle.stl**

---



**arm-nut-1-right-x-3.stl**

---



**wire-1-top.stl**

---



**wire-2-right.stl**

---



**arm-end-2-x3.stl**

---



**back-shroud-right.stl**

---



**arm-center-left-2-x3.stl**

---



**main-body-bottom.stl**

---



**arm-center-right-2-x-3.stl**

---



**arm-nut-1-left-x-3.stl**

---



**arm-bolt-x-3.stl**

---



**main-body-top.stl**

---



**wire-3-left.stl**

---



**front-shroud-left.stl**

---



**arm-joint-x-3.stl**

---



**light-tube-cover.stl**

---



**light-tube.stl**

---



**barrel.stl**

---



front-shroud-right.stl

## License ©

This work is licensed under a  
**Creative Commons (4.0 International License)**



**Attribution-NonCommercial**

---

- ✗ | Sharing without ATTRIBUTION
- ✓ | Remix Culture allowed
- ✗ | Commercial Use
- ✗ | Free Cultural Works
- ✗ | Meets Open Definition