

FPV-Rover V2.0 (Tank)



Markus_p

[VIEW IN BROWSER](#)

updated 18. 5. 2023 | published 18. 5. 2023

Summary

It's finally here. Version 2.0 of the FPV-Rover for 540 motors.

[Hobby & Makers](#) > [RC & Robotics](#)

Tags: [car](#) [fpv](#) [tank](#) [rover](#) [speed](#) [speedtank](#) [arduino](#)
[control](#) [panzer](#) [remote](#) [remotecontrol](#) [remotecontrolled](#)
[fpvrover](#) [rccar](#) [fpvcamera](#) [fpvcameramount](#) [rc](#) [rcrover](#)
[rctank](#) [tanktracks](#)

It's finally here. Version 2.0 of the FPV-Rover.

This is the second version of the FPV-Rover.

This one is with 540 motor. This was requested a lot on the other version and I redesigned the whole rover (although it looks the same) for this change.

<https://www.youtube.com/watch?v=dpUSdjNppN0&feature=youtu.be>
https://www.youtube.com/watch?v=lbQW_ebiLKA

Instructions and BOM can be found on Instructables
<https://www.instructables.com/id/FPV-Rover-V20>.

Last Update 30.09.2020

Two additional parts (inner frame left high and inner frame right high) uploaded to the files.

Latest update: 27.03.2020

This is the next major update of the FPV-Rover.

A lot of parts have been redesigned to save material and print time. And to reduce support on the parts needed.

Some changes:

- less material in main body
- camera cutout in main body smaller
- enforced ventilation holes in the inner frames
- cutout in the inner frame to have more space
- less material in outer frame
- ability do screw external modifications to the outer frame (new projects)
- added a bevel gear with a ratio of 4:1 additional to 2:1. This reduces motor overheating and increases torque
- new ESC mount

This remix is based on



FPV-Rover V2.0 (RC Tank)

by markus_p

Model files



body-rover-v13.stl



camera-mount-left-v11.stl



camera-mount-right-v11.stl



camera-mount-main-v11.stl



small-cog-v2.stl



big_track_v11.stl



rubbertrack-v12.stl



rear-main-cog-v13.stl

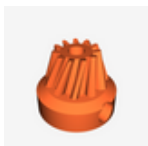

small-bevel-gear-41-v11.stl



tow-bar-plug-v12.stl



esc-mount-right-v12.stl



track-v13.stl

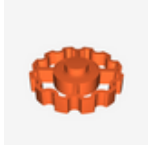

front-main-cog-v13.stl

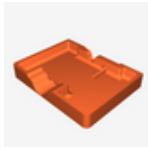

esc-mount-left-v12.stl



rear-cover-v12.stl



small-bevel-gear-21-v11.stl



top-parts-v15.stl



big-bevel-gear-21-v11.stl



outer-frame-v13.stl



led-mount-v12.stl



front-cover-v13.stl



inner-frame-right-high-v10.stl



inner-frame-left-high-v10.stl

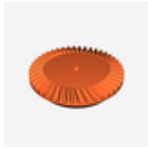

big-bevel-gear-41-v13.stl



motor-mount-v13.stl

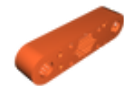

inner-frame-left-v15.stl



inner-frame-right-v15.stl

[Find source .stl files on Thingiverse.com](#)

License ©



This work is licensed under a
Creative Commons (4.0 International License)

Attribution—Noncommercial—Share Alike

- ✗ | Sharing without ATTRIBUTION
- ✓ | Remix Culture allowed
- ✗ | Commercial Use
- ✗ | Free Cultural Works
- ✗ | Meets Open Definition