



## Wall LED Lamp



Ivancho

[VIEW IN BROWSER](#)

updated 23. 11. 2022 | published 23. 11. 2022

### Summary

This is a LED wall lamp that I designed, to be similar to a lamp I once saw in IKEA.

[Household](#) > [Living Room](#)

Tags: [wall](#) [lamp](#) [led](#)

This is a LED wall lamp that I designed to be similar to a lamp I once saw in IKEA. You will need two LED bulb sockets that are designed to be mounted via M3 allen screws (mine have the mounting holes 12 mms apart), two LED bulbs, four M3 10 mm screws and four 3m heat set threaded inserts.

Designed to be printed without supports. I printed mine on PETG using a Prusa i3 MK3S+ printer. Printed with 10% infill since I don't expect these lamps to have stress.

The technique to place the heat set threaded inserts is described in <https://coloringchaos.github.io/form-fall-16/joints>

Designed in Fusion 360 - original files are included if you need to make changes.

# Model files

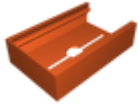

**box-v2-bottom.3mf**

---



**box-v2-top.3mf**

---



**box-nut.3mf**

---



**internal-shaft-support.3mf**

---



**main-shaft.3mf**

---



**connector-v2.3mf**

---



**lamp-complete.3mf**

---



**lamp-v23.f3d**

# License

This work is licensed under a  
**Creative Commons (4.0 International License)**



## **Attribution-NonCommercial**

---

- ✗ | Sharing without ATTRIBUTION
- ✓ | Remix Culture allowed
- ✗ | Commercial Use
- ✗ | Free Cultural Works
- ✗ | Meets Open Definition