

Robust Keyboard Wall Mount



mrusk

[VIEW IN BROWSER](#)

updated 13. 1. 2024 | published 13. 1. 2024

Summary

A simple, but extremely stable wall mount for keyboards

[Gadgets](#) > [Computers](#)

Tags: [wallmount](#) [keyboard](#)

A simple but very stable wall mount for any keyboard. Specialty is the reinforced bottom avoiding breaking it on heavy use as with other designs.

Use stable double-sided adhesive to mount, e.g. Tesa Powerbond Ultra Strong.

Model files

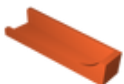

keyboard-mount-left.stl

keyboard-mount-right.stl

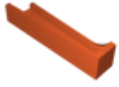

License ©

This work is licensed under a
[Creative Commons \(4.0 International License\)](#)



Attribution-NonCommercial

- ✗ | Sharing without ATTRIBUTION
- ✓ | Remix Culture allowed
- ✗ | Commercial Use
- ✗ | Free Cultural Works
- ✗ | Meets Open Definition