



## Ender 3 Pro

**N** NuntiuX

[VIEW IN BROWSER](#)

updated 27. 5. 2020 | published 27. 5. 2020

### Summary

Changed design to be able to print on ender 3 pro

---

[Hobby & Makers](#) > [Tools](#)

---

Changed design to be able to print on ender 3 pro

### This remix is based on

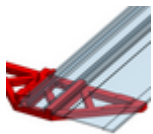

**Track Saw Fence**

by Timo

### Model files



**festool-track-fence.stl**

---



festool-track-fence.skp

## License ©

This work is licensed under a  
**Creative Commons (International License)**



**Public Domain**

---

- ✓ | Sharing without ATTRIBUTION
- ✓ | Remix Culture allowed
- ✓ | Commercial Use
- ✓ | Free Cultural Works
- ✓ | Meets Open Definition