

3D MODEL ONLY

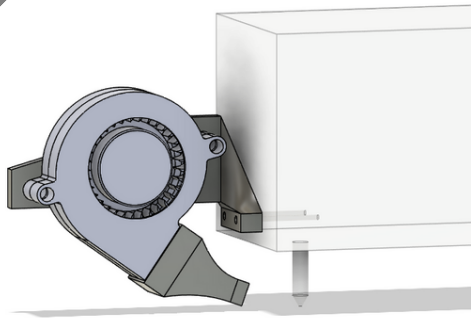

NF Wind 5010 Fan Mount and Air Directing Nozzle



airnozzle

[VIEW IN BROWSER](#)

updated 24. 11. 2022 | published 24. 11. 2022

Summary

This is a 5010 fan mount for the NF Wind extruder with airflow directing nozzle

[3D Printers](#) > [3D Printers - Upgrades](#)

Tags: [extruder](#) [fan](#) [cooling](#) [fanmount](#) [partcooling](#) [5010](#)
[nfwind](#)

You will need two M2x6 bolts to mount the bracket on the extruder and two M4x10 bolts with two M4 nuts to mount the fan to the bracket.

The NF Wind extruder has two M2 holes in front you can use for this. The bracket has two M4 nut cutouts, so you can screw in the bolts without applying counter-pressure.

The front of the bracket is designed in a way as to leave enough space for the gear lever, so you can release filament without unmounting the bracket.

Fanholder.stl is for the NF Wind left version and Fanholderright.stl is for the NF Wind right version.

The Airflow nozzle is press fit right on the 5010 fan. It's not necessary for good cooling, but it increases pressure as well as directs air away from the heaterblock.

Model files

fanholder.stl



fanholder_right.stl



airnozzle.stl



License ©



This work is licensed under a
[Creative Commons \(4.0 International License\)](https://creativecommons.org/licenses/by-nc/4.0/)

Attribution-NonCommercial

- ✗ | Sharing without ATTRIBUTION
- ✓ | Remix Culture allowed
- ✗ | Commercial Use
- ✗ | Free Cultural Works
- ✗ | Meets Open Definition