

Synth PCB panel clamp

 **Rich Holmes**

[VIEW IN BROWSER](#)

updated 15. 3. 2023 | published 15. 3. 2023

Summary

Clamp to secure a PCB to a front panel, e.g. for a synth module

[Hobby & Makers](#) > [Electronics](#)

I build synth modules in Kosmo format, which is electrically (almost) the same as Eurorack but larger. Eurorack PCBs can be used to make Kosmo modules, but board mounted pots are usually too close together and jacks are too small, so need to be replaced with panel mounted parts. Some PCBs are meant to be mounted to the front panel using these board mounted parts, so in such a case a solution like this is needed to secure the PCB to the panel. The bottom piece fits between a pot and the panel. A pan head M4 or M5 machine screw holds the two parts together and clamps the PCB in between. (In the photo, I didn't have a pan head screw the right size, so I improvised with an additional nut on a flat head screw.)

This remix is based on

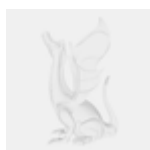

Onshape

Model files



pcb_clamp_b_m4.stl

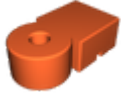

pcb_clamp_t_m4.stl



pcb_clamp_b_m5.stl

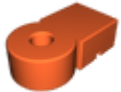

pcb_clamp_t_m5.stl

[Find source .stl files on Thingiverse.com](https://www.thingiverse.com/thing:4584848)

License ©

This work is licensed under a
[Creative Commons \(International License\)](https://creativecommons.org/licenses/by/4.0/)



Public Domain

- ✓ | Sharing without ATTRIBUTION
- ✓ | Remix Culture allowed
- ✓ | Commercial Use
- ✓ | Free Cultural Works
- ✓ | Meets Open Definition