



## Cheshire Cat



reddadsteve

[VIEW IN BROWSER](#)

updated 18. 2. 2019 | published 18. 2. 2019

### Summary

Cheshire Cat from Alice and Wonderland I had a lot of purple ABS left over from my last project (Dino Flintstone) and...



N/A



22 pcs



0.20 mm



0.40 mm



PLA



N/A



Prusa  
MK3/S/S+

[Toys & Games](#) > [Action Figures & Statues](#)

Tags: [cat](#) [animal](#) [wonderland](#)

#### Cheshire Cat from Alice and Wonderland

I had a lot of purple ABS left over from my last project (Dino Flintstone) and decided on building the Cheshire Cat. Since my daughter loves Alice in Wonderland, this was an easy choice to make.

The model as printed is 25cm high and 28cm long, however since it is sliced into pieces to allow for the colors, you only need to check the size of the largest flat piece (body\_6.stl, approx 130mm x 125mm) to determine your print size. The tallest piece is head.stl, 63mm. The model should scale well except for the eyes (just the black dots) and whiskers.

I used glow in the dark ABS for the mouth for that extra special touch.

**Gcode files for the MK3 were supplied by maker "DORFFMEISTER", thank you!**

Enjoy!

## **Print instructions**

Rafts: No  
Supports: No  
Resolution: .2mm  
Infill: 10%

Notes:\*\*

See important notes in the 'extra notes for printing' section for the black eyes and whisker pieces.

I printed all the parts except for the head with one shell. I printed the head with two shells due to the 'extreme' overhangs (60 degrees max) which I am always cautious with.

## **Building the model**

### **Colors**

pink:  
face

ear\_r  
ear\_l

arml\_1  
arml\_3  
arml\_5  
arml\_7

armr\_1  
armr\_3  
armr\_5  
armr\_7

arm\_bump (two copies)

tail\_2  
tail\_4  
tail\_6  
tail\_8

body\_1  
body\_3  
body\_5  
body\_7  
body\_9  
body\_11  
body\_13

body\_bump (four copies)

purple:  
head

arml\_2  
arml\_4  
arml\_6

armr\_2  
armr\_4  
armr\_6

tail\_1  
tail\_3  
tail\_5  
tail\_7  
tail\_9

body\_2  
body\_4  
body\_6  
body\_8  
body\_10  
body\_12  
body\_14

white (or glow in the dark):  
teeth\_1  
teeth\_2  
teeth\_3

black:  
eyebrow\_r  
eyebrow\_l

eye\_r  
eye\_l

whisker\_l (three copies)  
whisker\_r (three copies)

yellow:  
eyeball\_r  
eyeball\_l

### **Extra notes for printing**

Rafts are not required, except for the eye\_r and eye\_l parts due to the small sizes.

Be sure to thoroughly clean any first layer 'squish'. Depending on your first layer squish, you may need to resize the bumps to reduce their height. Without a first layer squish all pieces fit perfectly.

Due to the narrow size of the whiskers, I printed them with 0% infill and 0 bottom layers. This allows them to be squeezed into the narrow whisker slots on the face. Alternatively you can simply sand them down to fit.

Extra copies of parts:  
Three copies of whisker\_r  
Three copies of whisker\_l  
Four copies of body\_bump  
Two copies of arm\_bump

### **Assembly**

The assembly diagram in the pictures section shows all connections. To keep the diagram somewhat readable, for the tail, body and arms I simply labeled the first and last piece for each of those sections. All numbered pieces are to be assembled in order.

Special notes to be aware of:

1-Take care to note left and right pieces. They look quite similar but are actually different.

2-The whiskers could be problematic if the model is resized. At the standard size, the whiskers actually fit quite well if you follow the whisker instructions above.

3-There is a fair amount of gluing to be done. I wound up gluing pieces in pairs, letting the glue settle a bit then gluing pairs together. Also, masking tape worked great in holding pieces together while waiting for the glue to dry.

4-Glue the tail together.

5-Glue the body together. See the diagram for the body\_bump position.

6-Glue the body and tail together.

7-When gluing the arms, create each arm (including the arm\_bump) without the hands. Glue the arms to the body. Interlock the hands together and then glue them between the arms. It's simpler than it sounds, but if you glue the hands first, you may not be able to fit the arms into the body.

A few people have installed the hands upside down and did not realize it until after the glue dried. Be sure that the slight dent in the hands face up and fit into the chin. The rounded side rests on the ground.

8-Be sure that the bottom of the hands rest on the table surface, even with the body. When placing the head, the head will rest on the hands and fit into the body.

9-Push the eyes into the eyeballs, then glue the eyeballs, ears and eyebrows into the head.

10-insert the whiskers and teeth into the face. When inserting the teeth into the face, put in teeth\_1 and teeth\_3 first. Be sure they are all the way in and then insert teeth\_2 between them.

11-Glue the face and head together

12-The last step should be to glue the full head/face to the body (the head is rotated), while the chin rests on the hands.

Note-The body and tail are hollow (I wanted to cut down on print time). If you are handy, you might consider putting a light inside the model!

## Model files

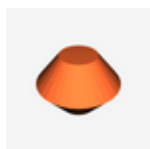

**body\_bump.stl**

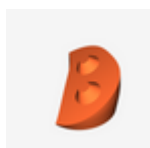

**armr\_2.stl**



**teeth\_2.stl**

---



**arm\_l\_2.stl**

---

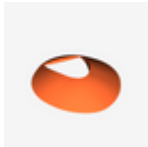

**body\_1.stl**

---



**body\_8.stl**

---



**ear\_r.stl**

---

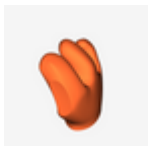

**arm\_r\_7.stl**

---



**tail\_5.stl**

---



**ear\_l.stl**

---



**body\_13.stl**

---

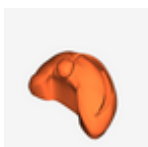

**face.stl**

---

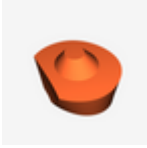

**armr\_5.stl**

---

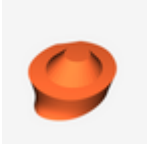

**armr\_6.stl**

---



**tail\_9.stl**

---



**arml\_7.stl**

---



**whisker\_l.stl**

---



**whisker\_r.stl**

---



**armr\_1.stl**

---

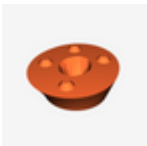

**tail\_7.stl**

---

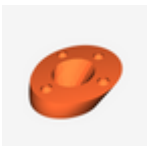

**tail\_6.stl**

---



**arml\_3.stl**

---



**arml\_6.stl**

---



**tail\_3.stl**

---



**body\_5.stl**

---

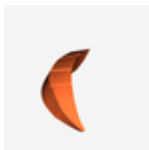

**teeth\_3.stl**

---



**tail\_2.stl**

---

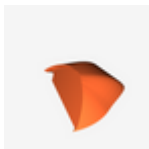

**body\_14.stl**

---



**eye\_r.stl**

---



**arml\_4.stl**

---

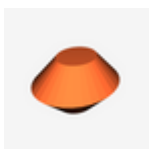

**arm\_bump.stl**

---



**eye\_l.stl**

---





**body\_10.stl**

---



**body\_4.stl**

---



**body\_2.stl**

---



**body\_9.stl**

---



**head.stl**

---



**teeth\_1.stl**

---

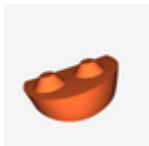

**armr\_3.stl**

---



**arml\_1.stl**

---

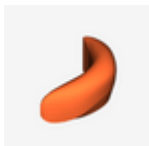

**eyebrow\_l.stl**

---



**tail\_4.stl**

---



**body\_11.stl**

---



**eyeball\_l.stl**

---



**eyebrow\_r.stl**

---



**body\_7.stl**

---

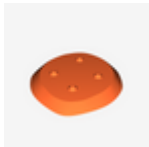

**body\_3.stl**

---



**body\_6.stl**

---



**armr\_4.stl**

---



**tail\_1.stl**

---

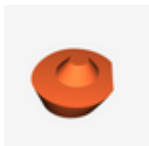

**arml\_5.stl**

---



**eyeball\_r.stl**

---

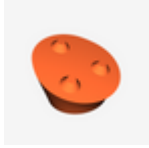

**tail\_8.stl**

---



**body\_12.stl**

---

## Print files

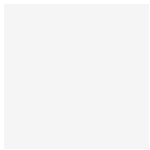

**\_purple-head-210c\_10per\_020mm\_5h\_8m\_46grams\_cos.gcode**

---

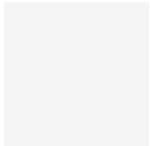

**\_pink-arms-ears-face-tail-210c\_10per\_020mm\_13h\_.gcode**

---

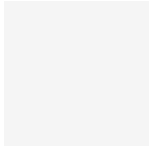

**\_purple-body-2-6-8-14-210c\_10per\_020mm\_7h\_5m\_82.gcode**

---

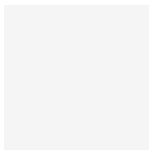

**\_pink-body-1-5-7-210c\_10per\_020mm\_6h\_14m\_70gram.gcode**

---

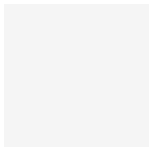

**\_yellow-eyeballs-210c\_10per\_020mm\_0h\_14m\_2grams.gcode**

---

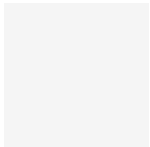

**\_black-eye-balls-eye-brows-whiskers-210c\_10per\_.gcode**

---

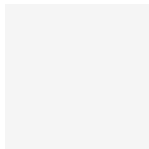

**[\\_pink-body-3-9-11-13-210c\\_10per\\_020mm\\_9h\\_16m\\_11.gcode](#)**

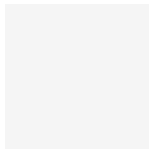

**[\\_purple-body-4-10-12-210c\\_10per\\_020mm\\_7h\\_9m\\_84g.gcode](#)**

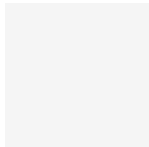

**[\\_purple-arms-tail-210c\\_10per\\_020mm\\_9h\\_4m\\_92gram.gcode](#)**

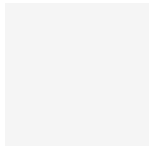

**[\\_white-teeth-210c\\_10per\\_020mm\\_0h\\_55m\\_8grams\\_cos.gcode](#)**

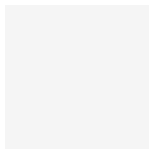

**[\\_pink-arms-bumps-body-bumps-210c\\_10per\\_020mm\\_0h.gcode](#)**

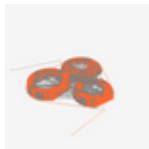

**[purple-body-4-10-12-210c\\_10per\\_020mm\\_7h\\_9m\\_84gr.gcode](#)**

🌀 PLA 🌀 0.40 mm ≡ 0.20 mm



**[pink-body-3-9-11-13-210c\\_10per\\_020mm\\_9h\\_16m\\_112.gcode](#)**

🌀 PLA 🌀 0.40 mm ≡ 0.20 mm

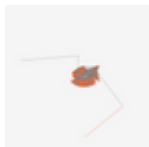

**[white-teeth-210c\\_10per\\_020mm\\_0h\\_55m\\_8grams\\_cost.gcode](#)**

🌀 PLA 🌀 0.40 mm ≡ 0.20 mm



**[pink-arms-ears-face-tail-210c\\_10per\\_020mm\\_13h\\_1.gcode](#)**

🌀 PLA 🌀 0.40 mm ≡ 0.20 mm



### **black-eye-balls-eye-brows-whiskers-210c\_10per\_0.gcode**

🌀 PLA 🌀 0.40 mm ≡ 0.20 mm



### **yellow-eyeballs-210c\_10per\_020mm\_0h\_14m\_2grams\_.gcode**

🌀 PLA 🌀 0.40 mm ≡ 0.20 mm



### **purple-head-210c\_10per\_020mm\_5h\_8m\_46grams\_cost.gcode**

🌀 PLA 🌀 0.40 mm ≡ 0.20 mm



### **purple-body-2-6-8-14-210c\_10per\_020mm\_7h\_5m\_82g.gcode**

🌀 PLA 🌀 0.40 mm ≡ 0.20 mm



### **purple-arms-tail-210c\_10per\_020mm\_9h\_4m\_92grams.gcode**

🌀 PLA 🌀 0.40 mm ≡ 0.20 mm



### **pink-arms-bumps-body-bumps-210c\_10per\_020mm\_0h\_.gcode**

🌀 PLA 🌀 0.40 mm ≡ 0.20 mm



### **pink-body-1-5-7-210c\_10per\_020mm\_6h\_14m\_70grams.gcode**

🌀 PLA 🌀 0.40 mm ≡ 0.20 mm

[Find source .stl files on Thingiverse.com](#)

## **License ©**

This work is licensed under a  
**Creative Commons (4.0 International License)**



## Attribution-NonCommercial

---

- ✗ | Sharing without ATTRIBUTION
- ✓ | Remix Culture allowed
- ✗ | Commercial Use
- ✗ | Free Cultural Works
- ✗ | Meets Open Definition