



Cleat 100 - 160 (Klampe)



Georg

[VIEW IN BROWSER](#)

updated 22. 11. 2023 | published 22. 11. 2023

Summary

Cleat in various lengths (100 mm - 160 mm)

[Hobby & Makers](#) > [Organizers](#)

Tags: [cleat](#) [rope](#) [seilklampe](#)

I remodeled the cleat from Wilko in Solidworks with a couple of lengths.

You can choose between 100 mm to 160 mm in steps of 10 mm. The holes stay the same diameter, but change in distance. So be carefull not to drill the holes and change the cleat then.

Use 5mm counter sink screws.

I also uploated the Solidworks model for your own modifications.

You will need support for printing the model.

If you like the model you can [buy me a coffee](#). :)

This remix is based on



Cleat 01 - 03

by Wilko

Model files



3MF

7 files

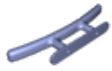

cleat_160.3mf



cleat_150.3mf



cleat_140.3mf



cleat_130.3mf



cleat_120.3mf



cleat_110.3mf



cleat_100.3mf



cleat.sldprt

License ©

This work is licensed under a
Creative Commons (4.0 International License)



Attribution

- ✗ | Sharing without ATTRIBUTION
- ✓ | Remix Culture allowed
- ✓ | Commercial Use
- ✓ | Free Cultural Works
- ✓ | Meets Open Definition