



Ikea Trofast hydroponics kit



Oleksii Zelivianskyi

[VIEW IN BROWSER](#)

updated 14. 4. 2023 | published 14. 4. 2023

Summary

Ikea Trofast ebb and flow (flood and drain) hydroponics system kit

[Household](#) > [Outdoor & Garden](#)

Tags: [ikea](#) [grow](#) [growing](#) [trofast](#) [hydroponics](#) [drain](#) [hydroponic](#) [flood](#) [ebb](#) [hydroponicsystem](#) [ebbandflow](#) [flood](#)

This is my ebb and flow (flood and drain) hydroponics system project made with Ikea Trofast boxes.

You have to print inlet and inlet holder, drainage and drainage holder, two nuts and two corners. Corners are used to make an angle and mounted on drainage side, so nutrient solution drain back to the reservoir via inlet. The inlet uses 12 mm hose (my pump has the same hose connector).

Everything is printed without supports, holders should be turned over to print, I used PETG plastic to print.

You have to make sure that your pump does not outpowers the drainage.

Updates:

14.04.2023 - added water level sensor holder

06.04.2023 - first published

Model files



inlet.stl



inlet_holder.stl



drainage.stl

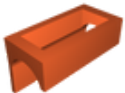

drainage_holder.stl



nut.stl



corner.stl



level_sensor_holder.stl

License

This work is licensed under a
Creative Commons (4.0 International License)



Attribution-NonCommercial

- ✗ | Sharing without ATTRIBUTION
- ✓ | Remix Culture allowed
- ✗ | Commercial Use
- ✗ | Free Cultural Works
- ✗ | Meets Open Definition