

## 1/4" camera mount that Snaps on 2020 profile.



Furiku

[VIEW IN BROWSER](#)

updated 12. 4. 2022 | published 28. 10. 2020

## Summary

This is a 1/4 inch (1,4" screw) camera mount which snaps on 2020 extrusion.

[3D Printers](#) > [3D Printers - Upgrades](#)

Tags: [cameramount](#) [2020](#) [2020extrusion](#) [actioncam](#)  
[ekenh9r](#)

This is a 1/4 inch (1,4" screw) camera mount which snaps on 2020 extrusion. Suitable for small cameras like action cameras.

Feel free to use however you like and remix.

## Print instructions Category: 3D Printer Accessories Summary

This is a 1/4 inch (1,4" screw) camera mount which snaps on 2020 extrusion. Suitable for small cameras like action cameras.

Feel free to use however you like and remix.

# Model files

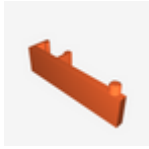

camera\_mount\_1\_4\_thread\_snaps\_2020\_extrusion.stl

[Find source .stl files on Thingiverse.com](#)

## License ©

This work is licensed under a  
**Creative Commons (International License)**



**Public Domain**

- 
- ✓ | Sharing without ATTRIBUTION
  - ✓ | Remix Culture allowed
  - ✓ | Commercial Use
  - ✓ | Free Cultural Works
  - ✓ | Meets Open Definition