



## Holder for Paspberry PI camera module



Dimitar Tanchev

[VIEW IN BROWSER](#)

updated 27. 3. 2024 | published 27. 3. 2024

### Summary

Camera mount for the Raspberry Pi Camera module (compatible with V1.3, V2.1). You will need some screws - M3 (and...

[Gadgets](#) > [Photo & Video](#)

Tags: [camera](#) [holder](#) [mount](#) [cameramount](#) [raspberrypi](#)  
[cam](#) [thingiverse](#) [raspberrypicamera](#)

Camera mount for the Raspberry Pi Camera module (compatible with V1.3, V2.1).

You will need some screws - M3 (and nuts) for the holder, and M2 for the camera lid.

You must place the spacers, between the lid and camera.

# Model files

**holder-base\_mexus.stl**



**2020-mount\_mexus.stl**



**holder\_rib2\_mexus.stl**

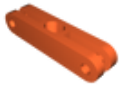

**camera\_lid\_mexus.stl**

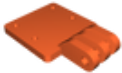

**holder\_rib1\_mexus.stl**

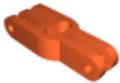

**spacers\_mexus.stl**

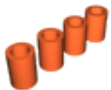

**camera\_base\_mexus.stl**



[Find source .stl files on Thingiverse.com](#)

## License ©

This work is licensed under a  
[Creative Commons \(4.0 International License\)](#)



## Attribution

---

- ✘ | Sharing without ATTRIBUTION
- ✔ | Remix Culture allowed
- ✔ | Commercial Use
- ✔ | Free Cultural Works
- ✔ | Meets Open Definition