

Large Radius Gauge - Metric



kaje

VIEW IN BROWSER

updated 24. 2. 2023 | published 24. 2. 2023

Summary

These are radius gauges for large radii - eleven gauges covering the range from 50mm to 1000mm.

[Hobby & Makers](#) > [Tools](#)

Tags: [gage](#) [curve](#)

These are radius gauges for large radii - eleven gauges covering the range from 50mm to 1000mm. Each edge of the gauge is either a convex or concave radius. Files for a box to hold the gauges are included.

These gauges are useful when you need to design something to fit closely to a large curved surface; at a minimum they can provide a starting point for making a test fit.

For similar gauges in inch measurements, see here :

<https://www.prusaprinters.org/prints/44577-large-radius-gauges-inch>

The OnShape 3D CAD files for these are here :

<https://cad.onshape.com/documents/a83602a6c9a85d3acac1716b/w/afa0b6de20e08b2db58c1d02/e/3a046c692da065fcfa57bf83>

Print instructions

Print in PLA using the 3mf files provided;; otherwise :

- 100% infill
- top/bottom infill = concentric

I recommend printing in orange or yellow - makes it easier to find them on your messy bench in the shop!

This remix is based on



Onshape

Model files

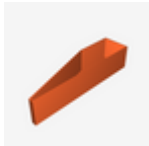

box-holder.stl



box-holder.3mf



box-lidmetric.3mf



box-lidmetric.stl

r100.stl

r200-gauge.stl

r1000-gauge.stl

r700-gauge.stl

r600-gauge.stl

r500-gauge.stl

r400-gauge.stl

r300-gauge.stl

r900-gauge.stl

r800-gauge.stl

r050.stl

[Find source .stl files on Thingiverse.com](#)

License

This work is licensed under a
Creative Commons (International License)



Public Domain

- ✓ | Sharing without ATTRIBUTION
- ✓ | Remix Culture allowed
- ✓ | Commercial Use
- ✓ | Free Cultural Works
- ✓ | Meets Open Definition

