

Voilà Table Stick Clamp 80mm V3.0



Waebis-Lab

[VIEW IN BROWSER](#)

updated 30. 6. 2023 | published 30. 6. 2023

Summary

Sustainable multifunctional table clamp, for tools, cameras, lighting, headphones.



5.60 hrs



1 pcs



0.30 mm



0.40 mm



PLA



93 g



Prusa
MK3S/S+ &
MMU2S

[Household](#) > [Office](#)

Tags: [camera](#) [office](#) [organizer](#) [mount](#) [earphone](#) [light](#)
[webcam](#) [illumination](#) [montage](#) [clamp](#) [table](#) [stick](#)
[headphone](#) [screw](#) [holder](#) [stand](#) [cameramount](#) [workshop](#)
[adjustable](#)

This is the version 3 of my sustainable multifunctional table clamp, for tools, cameras, lighting, headphones.

The main use is to hold a stick, that has 30mm or one inch in diameter.

This version has optional two 3mm threaded rods inside which has a M3 nut on each side.

That give a tension to the raiser body, pulls it together, so it cannot break apart too easy.

Also it is wider than previous versions (now 60mm) so in general it got more durable.

The hot melt brass inserts ensure that the 30mm stick is well secured.

The hole design is split in many parts, you should not need to reprint the whole clamp if a print fails or application changes. That is why I think it is sustainable.

Raiser:

The 'Raiser' and its 'Raiser Back Cover' are different in height.

It holds the upper and the lower clamp with 8x M6 cylinder allen screws together.

The thread in the raiser is 40mm, so a M6x40 fit best.

Just choose the height of the raiser greater than the thickness of the table plate.

It has a hole of 30mm. I use a leg from a do it yourself shop to slide in.

With the inserted 'Adapter Metric To Inch' the hole fits to a one Inch stick.

There is a space for the adapter on top and on the bottom.

The stick holds with one or two M6x10mm screw in place.

There is a piece called inlay. Slide that into the raiser (on top, or also on bottom), so it will be between the clamp screw an the stick.

This prevents the stick from getting screw marks.

On the stick you can mount lamps, cameras and whatever.

The raiser has a large chamfer, for a closer fit to the corner of a L-shaped table.

Back Covers / Addons:

There are plenty of M3 treads on the backside, to mount different addons.

There are different back cover, that fit to the raisers and the clamps as standard..

Alternatively you use the earphone holder on top, or add just your design.

Headphone Holder:

The headphone holder fit just to the upper clamp.

Clamp Screws:

Choose a suitable M24 screw and the clamp will fit. Also steel screws will fit.

The clamp screws have lengths of 40 / 60 / 80 mm with a partial removed thread on top.

There you can attach a feet (with different heights) to the screws, to protect the table.

This increases the length of the screw for 10 or 20mm.

Attach the feet with a M10x10 or M10x12mm screw.

Do not overtighten that screw. I should just prevent the feet from fall off from the screw.

Adding a small rubber on the top of the feet may increase the grip the clamp have at all.

For lazy people there are square holes in the bottom, so you can use a ratchet set to easily tighten the screw.

That is nice to go a few times back and forth in the thread to make a smoother fit.

Of course those square holes are not too stable.

Just to tell:

The whole clamp should be pretty stable. I used PETG with 15% infill.

All smaller screws are M3.

The gap in all M24 threads are meant to give dirt a space to collect and fall out.

Kind of tap cleaner, because printed screws are rarely perfect.

Take care, the design is basically complete but some details may change!

Look to get the latest version of a part.

I tried to make a one inch stick here:

<https://www.printables.com/de/model/449137-one-inch-stick>

There is probably more to come...

We'll see what else I can think of.

If you have suggestions, I like to know ...

Model files

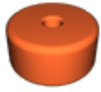

screw-feet-10mm-v23.stl

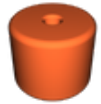

screw-feet-20mm-v23.stl



inlay-25mm-v23.stl



adapter-metric-to-inch-v23.stl



m24-clamp-screw-40mm-v23.stl



m24-clamp-screw-80mm-v23.stl



m24-clamp-screw-60mm-v23.stl

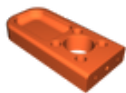

upper-clamp-v30.stl



raiser-back-80mm-v30.stl

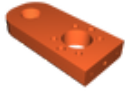

lower-clamp-v30.stl

Print files



raiser-back-80mm-v30_03mm_pla_mk3smmu2s_5h36m.gcode

PLA 0.40 mm 0.30 mm 5.60 hrs 93 g

Prusa MK3S/S+ & MMU2S

License

This work is licensed under a
Creative Commons (4.0 International License)



Attribution—Noncommercial—Share Alike

-
- ✗ | Sharing without ATTRIBUTION
 - ✓ | Remix Culture allowed
 - ✗ | Commercial Use
 - ✗ | Free Cultural Works
 - ✗ | Meets Open Definition