



## X2 Delta P Duct 3DO Nozzlecam Mount

 TrashprintGuy

[VIEW IN BROWSER](#)

updated 7. 4. 2023 | published 7. 4. 2023

### Summary

This is a Remix of the popular X2 Delta P Fanduct for installing the 3DO Nozzlecamera

[3D Printers](#) > [3D Printers - Upgrades](#)

Tags: [originalprusai3mk3](#) [prusai3mk3](#) [fanduct](#) [prusamk3s](#)  
[nozzlecamera](#) [nozzlecam](#) [3do](#)

The Camera just fits in the 7.8mm hole on the front of the fanduct

The electronic case and the USB kable is secured to the cable sheathing by using some zip tie's.

### This remix is based on

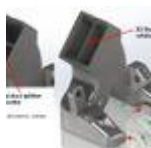

**[Remix] X2 Delta P Duct [V2R2.2] for the MK3S(+)  
[New Flow Splitter]**

by BuildX

Nozzle  
Camera  
Mount  
for Prusa  
3DO  
i3  
Nozzle  
MK3S+  
Camera  
Mount  
for Prusa  
i3  
MK3S+

## 3DO Nozzle Camera Mount for Prusa i3 MK3S+ by Clamikra

## Model files

**x2-delta-p-duct-v2r2\_2-3do-nozzlecam.3mf**

---

**nozzle-cam-3do-pcb-case-v9.3mf**

---

**nozzle-cam-3do-pcb-top-v9.3mf**

## License ©

This work is licensed under a  
**Creative Commons (International License)**



**Public Domain**

---

- ✓ | Sharing without ATTRIBUTION
- ✓ | Remix Culture allowed
- ✓ | Commercial Use
- ✓ | Free Cultural Works
- ✓ | Meets Open Definition