

Architecture Chess Set



3DPrintBunny

[VIEW IN BROWSER](#)

updated 12. 4. 2022 | published 3. 11. 2020

Summary

This is a simple architecture, or famous buildings, chess set. It includes pieces, a gift box and a chess board.

[Toys & Games](#) > [Board Games](#)

Tags: [kitchen](#) [gift](#) [architecture](#) [chess](#) [chessboard](#)
[chesspiece](#) [chessset](#) [eiffeltower](#) [chesspieces](#) [buildings](#)
[sydneyoperahouse](#)

This is a simple architecture, or famous buildings, chess set.

It includes pieces, a gift box and a chess board.

The buildings are: Eiffel Tower, Sydney Opera House, Heaven Temple, St. Basil's Cathedral, Empire State Building and the Burj Al Arab.

The gift box comes in two sizes the double height will hold both sets of pieces. I can personalise the box lid if you would like just let me know what text you would like.

The board is printed in two pieces (one in each colour) and can be slotted together without glue.

@3DPrintBunny

Model files



architecture_chess_lid.stl



heaven_temple.stl



st_basil_cathedral.stl

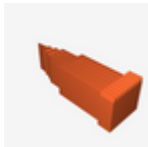

empire_state_building.stl



burj_al_arab.stl



sydney_opera_house.stl



box.stl



eiffel_tower.stl

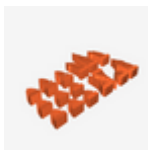

architecture_pieces_full_set.stl



chess_board_1cm_height.stl



architecture_chess_double_box.stl

[Find source .stl files on Thingiverse.com](#)

License ©

This work is licensed under a
Creative Commons (4.0 International License)



Attribution-NonCommercial

-
- ✗ | Sharing without ATTRIBUTION
 - ✓ | Remix Culture allowed
 - ✗ | Commercial Use
 - ✗ | Free Cultural Works
 - ✗ | Meets Open Definition