



Behind Monitor Laptop Mount [VESA]



BloodSteyn

[VIEW IN BROWSER](#)

updated 2. 10. 2023 | published 2. 10. 2023

Summary

An elegant and adjustable way to mount your laptop (various sizes) behind your monitor using the existing VESA Mounting.

[Gadgets](#) > [Computers](#)

Tags: [laptopstand](#) [verticallaptopstand](#) [laptopaccessories](#) [vesa](#) [monitormount](#) [vesa100](#) [vesa75](#) [vesamount](#) [laptopholders](#)

I have been looking for a way to mount my 17" Laptop behind my Dell 27" monitor using the VESA mount for quite some time now. The models I have been able to locate wouldn't work due to my monitor's VESA mount being recessed vs the general "surface mount" variants.

So I decided to take to TinkerCAD and try my hand at making one that would be specific to my needs, while still being universal enough for others to use.

Added sizing holes and locking pins to accomodate a few variations in laptop and screen sizes. 5 Holes, spaced 30mm apart.

Recommend Printing with 4 Walls, Bottoms and Tops for added strength. Print the Brackets Long Side Down to allow for maximum strength and no supports. They are hefty at 215mm long.

Also, you may need to print the Locking Pins slightly reduced in size to allow for shrinkage or expansion.

Please Note: This design is meant to work with **Laptops that can open to almost 180°** as the whole laptop will be sitting upright behind the screen.

Model files

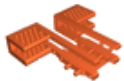

vesa-laptop-mount-dnp.stl

☐ Just the full assembled set, not for printing.



vesa_mount-10mm.stl

☐ Best one for general use

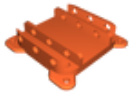

vesa_mount_mixed.stl

☐ 7.5mm and 10mm mounts

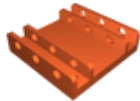

vesa_mount-75.stl

☐ 7.5mm mounts only

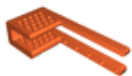

right_bracket.stl

☐ Right Bracket

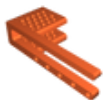

left_bracket.stl

☐ Left Bracket



locking_pins.stl

☐ Locking pins for height adjustment, print at reduced size to help them fit.

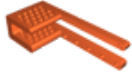

right_bracket_xtra.stl

☐ Right Bracket with Extra Hole to link with Left Side from more secure fit



left_bracket_xtra.stl

☐ Left Bracket with Extra Hole to link with Left Side from more secure fit

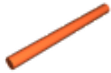

xtra_pin.stl

☐ Locking Pin to link Brackets with Extra Hole, good if it has a tight fit.

License ©



This work is licensed under a
[Creative Commons \(4.0 International License\)](https://creativecommons.org/licenses/by-nc/4.0/)

Attribution-NonCommercial

- ✗ | Sharing without ATTRIBUTION
- ✓ | Remix Culture allowed
- ✗ | Commercial Use
- ✗ | Free Cultural Works
- ✗ | Meets Open Definition