

## bambulab backside purge solution with a drawer



yahbluez

[VIEW IN BROWSER](#)

updated 7. 5. 2023 | published 7. 5. 2023

### Summary

KISS solution with a drawer for bambulab purge removing while printers is enclosed with no access to the back.

[3D Printers](#) > [3D Printers - Upgrades](#)

Tags: [bambu](#) [x1](#) [bambulab](#) [p1p](#) [ams](#) [x1c](#)

### TL;DR

A very good purge solution for bambulab printers inside of cabinets or enclosures, strongly following the **KISS** principle.

### update 2023.0507

- added a slimmer version, 50 mm wide at the left but 250 mm long
- FOLDER: slim version for IKEA 80cm shelf

### Collection

[tools, 3D printing](#)

## Motivation

Using a p1p inside of a **closed rack** to:

- silent the printer
- reduce the vibrations
- eliminate temperature fluctuations
- protect the printer against draft
- control the temperature
- keep it dry
- filter fume
- protect against fire
- secure the power network

Quickly run into the issue that the bambulab printer purge at the backside. A lot of purge! even without using the AMS.

No proper way to handle the backside or use one of the 300 purge collectors that needs to have access to the printers back side.

So this one with a big drawer was made.

## Let's get started

Print with PLA or PETG, this is a very easy print you need no supports. I use a strong 20x40x5 mm magnet to fix the purge box to the printer but this is optional.

There is no angle lower than 45° so you need no support for the ramp and no support for the magnet cave.

It's a functional part so i printed in draft on the hot sheet with 0.4mm nozzle without glue.

You may check the bed flatness with this test model upfront:

**flat bed** / <https://www.printables.com/model/303825-full-print-bed-many-printers/files>

You can use any sized magnet up to 40 x 20 x 5 mm best way to fix the magnet is a hot glue gun. You do not need a magnet it's just a nice to have.

The small coffin 600 is made for up to 600 purges, the big one can hold more than 1200 purges.

## Attribution

© yahbluez

## Can I sell copies of this?

Yes! Yahbluez shared this project under the GNU GPL v3.0 license. This license allows selling copies, but you must provide proper attribution and use the GPL 3.0 license, as detailed in the GPL v3.0 license itself. You have not the right to use any other licence than GNU GPL 3.0.

## Donation

If you like to donate you can buy me a coffee

## Filament used

extrudr PLA pale blue

## Model files



slim version for IKEA 80cm shelf

3 files

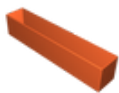

slim-50-long-250-coffin-600.stl

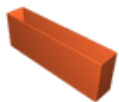

slim-50-long-250-coffin-1200.stl



slim-50-long-250-backyard.stl



3mf

4 files



set-purger-coffin600-bambustudio.3mf



**purger-bambustudio.3mf**

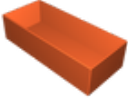

**coffin600-bambustudio.3mf**



**coffin1200-bambustudio.3mf**



**STL**

3 files

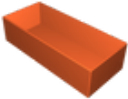

**coffin-600.stl**



**coffin-1200.stl**



**backyard.stl**

## License ©

This work is licensed under a  
**GNU**

**General Public License v3.0**



- ✗ | Sharing without ATTRIBUTION
- ✓ | Remix Culture allowed
- ✓ | Commercial Use
- ✓ | Meets Open Definition
- i | Share under the same license