



## BOSCH 18V Battery Storage/Support Holder (mounts on wall or under horizontal surface)



Nano

[VIEW IN BROWSER](#)

updated 26. 4. 2023 | published 26. 4. 2023

## Summary

BOSCH 18V Lithium Battery holder for storage purposes

[Hobby & Makers](#) > [Organizers](#)

Tags: [holder](#) [storage](#) [battery](#) [batteryholder](#) [bosch18v](#)

This holder is for BOSCH 18 volts lithium batteries.

The holder should be printed in the upright position and should require little to no support if your printer bridges well enough. I included two versions: one locking and one non locking. The locking one is shown here. Note that this one will require support for the top of the locking slot. IMHO, the locking version is not needed if you mount the holder to a vertical surface... (unless you

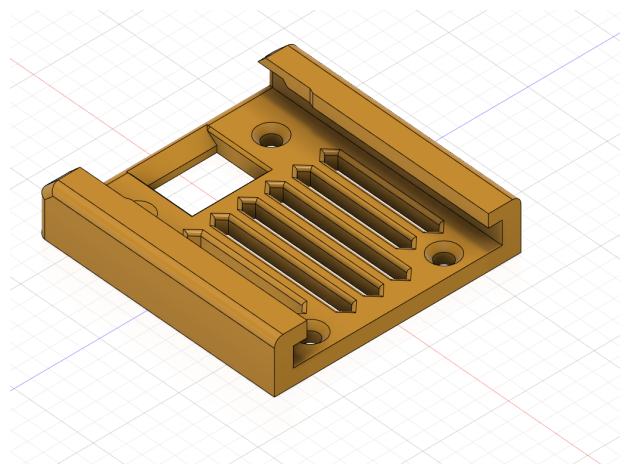

mount it upside down or sideways, which is also feasible).

I printed using PLA, 0.2 mm layer height at 20% gyroid infill, but I would recommend beefing up the infill to 40% around the holes and the locking slot for added strength.

Using these settings, the locking holder needs 25 grams of filament. The non-locking one needs 21.

## Model files



**bosch-battery-holder.stl**



**bosch-battery-holder-non-locking.stl**

## License ©

This work is licensed under a  
[Creative Commons \(4.0 International License\)](#)



**Attribution-NonCommercial**

- 
- ✗ | Sharing without ATTRIBUTION
  - ✓ | Remix Culture allowed
  - ✗ | Commercial Use
  - ✗ | Free Cultural Works
  - ✗ | Meets Open Definition