

Headphone Holder for 80/20 extrusion (or wall)



ecspot

[VIEW IN BROWSER](#)

updated 16. 11. 2020 | published 16. 11. 2020

Summary

Wanted something very simple to mount on my 80/20 desk.

[Household](#) > [Office](#)

Wanted something very simple to mount on my 80/20 desk. Made this so I could create more inserts for different types of things. Easily interchangeable. Minimal supports needed for insert. Base can print with no supports.

Made mounting holes large enough to secure with a 1/4-20 nut. sunken in so you could cap them to hide the nuts.

Print instructions

minimal supports required on insert. Body prints with no supports.

Model files



insert.stl

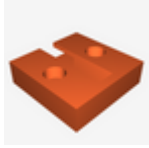

body.stl

License ©

This work is licensed under a
[Creative Commons \(4.0 International License\)](#)



Attribution

- ✗ | Sharing without ATTRIBUTION
- ✓ | Remix Culture allowed
- ✓ | Commercial Use
- ✓ | Free Cultural Works
- ✓ | Meets Open Definition