

## Train



PrusaLab

[VIEW IN BROWSER](#)

updated 15. 3. 2024 | published 15. 3. 2024

## Summary

Haptic model for the visually impaired, based on the book "Kamil – malíř snů" by Markéta Vítková.



11.46 hrs



2 pcs



0.20 mm



0.40 mm



PLA



140 g



Prusa  
MK3/S/S+

[Learning](#) > [Haptic Models](#)

Haptic model for the visually impaired, based on the book "**Kamil – malíř snů**" by Markéta Vítková.

Read more about the project on [PrusaLab's blog](#).

## Model files

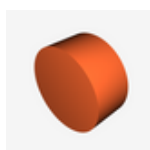

kolo\_velke\_2.stl



**vlacek.stl**

---



**kolo\_velke\_1.stl**

---

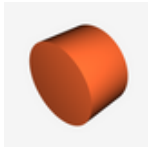

**kolo\_predek\_1.stl**

---



**kolo\_predek.stl**

## Print files



**kola\_02mm\_pla\_mk3s\_2h6m.gcode**

⚙️ PLA ⚙️ 0.40 mm ⚙️ 0.20 mm ⌚ 2.10 hrs ⚖️ 21 g 🖨️ Prusa MK3/S/S+

---

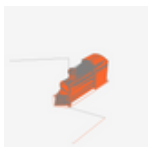

**vlacek\_02mm\_pla\_mk3s\_9h22m.gcode**

⚙️ PLA ⚙️ 0.40 mm ⚙️ 0.20 mm ⌚ 9.36 hrs ⚖️ 120 g 🖨️ Prusa MK3/S/S+

## License ©

This work is licensed under a  
[Creative Commons \(International License\)](#)

**Public Domain**

---



- ✓ | Sharing without ATTRIBUTION
- ✓ | Remix Culture allowed
- ✓ | Commercial Use
- ✓ | Free Cultural Works
- ✓ | Meets Open Definition