



Vintage car



PrusaLab

[VIEW IN BROWSER](#)

updated 15. 3. 2024 | published 15. 3. 2024

Summary

Haptic model for the visually impaired, based on the book "Kamil – malíř snů" by Markéta Vítková.



12.90 hrs



2 pcs



0.20 mm



0.40 mm



PLA



218 g



Prusa
MK3/S/S+

[Learning](#) > [Haptic Models](#)

Haptic model for the visually impaired, based on the book "**Kamil – malíř snů**" by Markéta Vítková.

Read more about the project on [PrusaLab's blog](#).

Model files



cele_bez_kol.stl

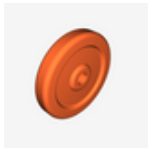

kolo1.stl

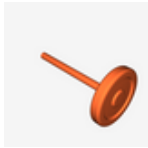

kolo.stl

Print files



kola_02mm_pla_mk3s_2h1m.gcode

🌀 PLA 🌀 0.40 mm ≡ 0.20 mm ⌚ 2.01 hrs ⚖️ 21 g 🖨️ Prusa MK3/S/S+

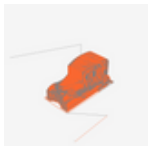

cele_bez_kol_02mm_pla_mk3s_10h53m.gcode

🌀 PLA 🌀 0.40 mm ≡ 0.20 mm ⌚ 10.89 hrs ⚖️ 197 g 🖨️ Prusa MK3/S/S+

License ©

This work is licensed under a
[Creative Commons \(International License\)](#)



Public Domain

-
- ✓ | Sharing without ATTRIBUTION
 - ✓ | Remix Culture allowed
 - ✓ | Commercial Use
 - ✓ | Free Cultural Works
 - ✓ | Meets Open Definition