



BigTreeTech TFT24 Mount



AlmightyFireFly

[VIEW IN BROWSER](#)

updated 26. 4. 2023 | published 26. 4. 2023

Summary

I like the original by scedux, but want a couple changes for mounting and viewing angle. Then I cleaned up the model...

[3D Printers](#) > [3D Printers - Upgrades](#)

Tags: [2020](#) [thingiverse](#) [tft24](#) [bigtreotech](#) [bigtreotechtft24](#)

I like the original by scedux, but want a couple changes for mounting and viewing angle. Then I cleaned up the model and made it easier to print. Turned out great!

Print Settings

Printer:

SainSmart Coreception

Rafts:

No

Supports:

No

Resolution:

.2

Infill:

15%

Filament:

Inland PLA+

Purple

Category: 3D Printer Parts

This remix is based on

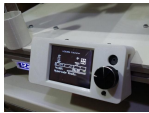

Bigtreetech TFT24 v1.1 Angled case for 2020 extrusion
by sdedux

Model files

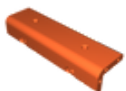

lcd_mount_tft24_3_v2.stl



lcd_cover_tft24_3_v2.stl



lcd_cover_tft24_3_v3.stl

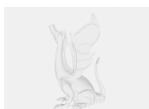

bigtreetech_tft24_mount_v3.step

License ©

This work is licensed under a
Creative Commons (4.0 International License)



Attribution

- ✗ | Sharing without ATTRIBUTION
- ✓ | Remix Culture allowed
- ✓ | Commercial Use
- ✓ | Free Cultural Works
- ✓ | Meets Open Definition