

# Pressure compensated Irrigation Dripper or Emitter

 **Praveen**

[VIEW IN BROWSER](#)

updated 26. 4. 2023 | published 26. 4. 2023

## Summary

Reverse engineered dripper to work at high water pressure 10 to 50 Psi (house water outlet)

[Household](#) > [Outdoor & Garden](#)

Tags: [dripper](#) [dripirrigation](#)

The reverse-engineered pressure compensation drippers were crafted from scratch, with a preference for printing the nozzle and outer part using 100% solid PETG/ABS material to ensure durability and withstand high pressure. These drippers are designed to thrive in drip irrigation conditions, maintaining a consistent workflow at working pressures of 10 to 50 PSI. Additionally, the inner part damper is printed in 100% solid TPU for optimal performance. Finally, Glued with super glue(only edges)

# Model files



dripper-bottom-part\_v1.3mf



top-part2.3mf

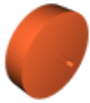

damber\_v1.3mf

## License ©



This work is licensed under a  
[Creative Commons \(4.0 International License\)](https://creativecommons.org/licenses/by-nc/4.0/)

**Attribution-NonCommercial**

- ✗ | Sharing without ATTRIBUTION
- ✓ | Remix Culture allowed
- ✗ | Commercial Use
- ✗ | Free Cultural Works
- ✗ | Meets Open Definition