



Nova PM Sensor SDS011 Air Quality Sensor box



Paše

[VIEW IN BROWSER](#)

updated 26. 4. 2023 | published 26. 4. 2023

Summary

A box for SDS011 laser dust particles concentration sensor. To be mounted on ceiling (under the roof)

[Hobby & Makers](#) > [Electronics](#)

Model files

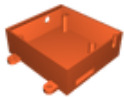

dustsensorbox.stl



dustsensorlid.stl

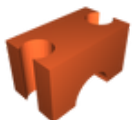

dustsensorclip.stl



dustsensoradapter.stl

License ©

This work is licensed under a
GNU



General Public License v2.0

- ✗ | Sharing without ATTRIBUTION
- ✓ | Remix Culture allowed
- ✓ | Commercial Use
- ✓ | Meets Open Definition
- i | Share under the same license