

Lelit Elizabeth steam arm

 **PrinterGuy74**

[VIEW IN BROWSER](#)

updated 29. 4. 2023 | published 29. 4. 2023

Summary

Steam arm for Lelit Elizabeth.

[Household](#) > [Kitchen](#)

The arm press fits with the stock knob and can be removed if needed.

By request I've created a Gaggia classic pro version. To get the sizing perfect print off the sizing model (about 15 mins to print) and adjust the scale %(try 102% to start) untill the sizing model fits snug then print off the lever at the same scale.

Model files



lelitbettysteamarm.stl

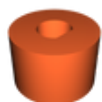

sizing-model.stl

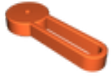

gaggiasteamlever.stl

License ©

This work is licensed under a
Creative Commons (4.0 International License)



Attribution—Noncommercial—Share Alike

- ✗ | Sharing without ATTRIBUTION
- ✓ | Remix Culture allowed
- ✗ | Commercial Use
- ✗ | Free Cultural Works
- ✗ | Meets Open Definition