

Prusa Mini (Mini+) Raspberry Pi Camera Module V2.1 8MP Mount With X Axis Strain Relief



TinkrMakr

[VIEW IN BROWSER](#)

updated 17. 2. 2021 | published 16. 12. 2020

Summary

Prusa Mini and Mini + Raspberry Pi Camera Module V2.1 8MP Mount With X Axis Strain Relief.



1.49 hrs



1 pcs



0.20 mm



0.40 mm



PET



13 g



Prusa MINI /
MINI+

[3D Printers](#) > [3D Printers - Upgrades](#)

Tags: [mini](#) [cameramount](#) [octoprint](#) [octopi](#) [prusamini](#)
[raspberrypicamera](#) [octoprintcamera](#) [octopicamera](#)

Prusa Mini and Mini + Raspberry Pi Camera Module V2.1 8MP Mount With X Axis Strain Relief. The mounts I could find did not give me the angle that I wanted. I like to have a clear view of the nozzle.

Added x axis strain relief to <https://www.prusaprinters.org/prints/45962-prusa-mini-raspberry-pi-camera-module-v21-8mp-moun> as suggested by Fanous.

UPDATE: Added a version to support cameras the are 4mm thick from to back at the ribbon cable. The original files supported cameras that are 3.6mm. Please measure your camera front to back at the ribbon cable plug to determine what version to use. 4mm version files are appended with 4mm in the file name.

UPDATE (2):

Berntzone has remixed for cameras that have more spacing between the camera and the board than the 4mm version will allow.

<https://www.prusaprinters.org/prints/49125-prusa-mini-raspberry-pi-camera-v21-mount-thicc>

4mm GCODE found under User Print Files

Original files support 3.6mm camera at ribbon cable.

Files appended with 4mm support cameras that are 4mm at ribbon cable.

Print instructions

This one does require supports.

UPDATE: Added a version to support cameras the are 4mm thick from to back at the ribbon cable. The original files supported cameras that are 3.6mm. Please measure your camera front to back at the ribbon cable plug to determine what version to use. 4mm version files are appended with 4mm in the file name.

Original files support 3.6mm camera at ribbon cable.

Files appended with 4mm support cameras that are 4mm at ribbon cable.

4mm GCODE found under User Print Files

This remix is based on



**Prusa Mini (Mini+) Raspberry Pi Camera Module V2.1
8MP Mount**

by TinkrMakr

Model files



pi-camera-mount-x-support.3mf



pi-camera-mount-left-v10.stl



pi-camera-mount-x-support-v18.stl

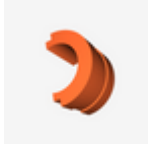

pi-camera-moun-x-support-backt-v19.stl



pi-camera-mount-x-support-4mm.3mf



pi-camera-mount-left-4mm.stl



pi-camera-mount-x-axis-strain-relief-4mm.stl

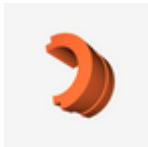

pi-camera-mount-x-support-back-4mm.stl



pi-camera-mount-4mm.step



pi-camera-mount.step

Print files



pi-camera-mount-x-support_02mm_petg_mini_1h30m.gcode

PET 0.40 mm 0.20 mm 1.49 hrs 13 g Prusa MINI / MINI+

License

This work is licensed under a
[Creative Commons \(4.0 International License\)](#)



Attribution—Noncommercial—Share Alike

-
- ✗ | Sharing without ATTRIBUTION
 - ✓ | Remix Culture allowed
 - ✗ | Commercial Use
 - ✗ | Free Cultural Works
 - ✗ | Meets Open Definition