



Plate Adhesive Brush and Bottle Organizer

 **CrisPaltenghe**

[VIEW IN BROWSER](#)

updated 29. 6. 2023 | published 29. 6. 2023

Summary

A handy organizer for clean/used brushes and a holder for the liquid plate adhesive

[3D Printers](#) > [Accessories](#)

Because I don't reuse a recently washed brush (until it dries), I have several brushes on hand when I do multiple prints. I personally prefer the Prevailant t-80 liquid plate adhesive for my Bambu Lab X1 because it goes on evenly and dries quickly. This little brush management organizer keeps my used, wet brushes separate from the clean, dry brushes while I am on a printing marathon. No support needed. On the Bambu X1, standard speed, it took 4 hrs and 125 grams of filament.

Model files

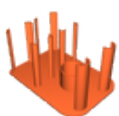

[plate-adhesive-brush-and-bottle-organizer.stl](#)

License

This work is licensed under a
Creative Commons (International License)



Public Domain

- ✓ | Sharing without ATTRIBUTION
- ✓ | Remix Culture allowed
- ✓ | Commercial Use
- ✓ | Free Cultural Works
- ✓ | Meets Open Definition